

Research #2



This toaster is efficient as it can cook numerous amounts of toast at a time and you don't have to cook them all at once which can be useful. It is a different design but it is effective. It is simple to use and is multifunctional. It could fit different types and sizes of toast at a time. It wouldn't take up much room on the bench. The shape of the design is interesting but is quite strange looking.



This is a simple square toaster with the normal pop up design. The colour and curved like design of the toaster makes it look quite modern and good for people who want a normal but interesting looking toaster. This toaster is good because it is multifunctional because the bit you put the toast in is placed so you can fit different (e.g. larger) types of toast in if needed. It would take up more space on the bench than the other design, ideas but still not much space.

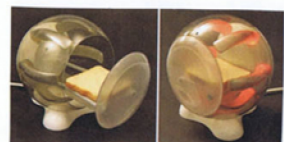
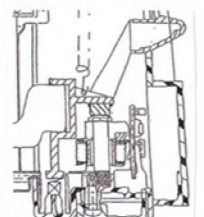

This is quite a different idea in cooking toast. You pull open the side of the toaster and put the toast in to cook it. It is an effective design. It wouldn't be very efficient because only one piece could be cooked at a time but you would be able to see into the toaster so you could check that your toast isn't burning which would be useful for the user. The design is interesting and effective. The modern type toaster might not take much power to run and wouldn't take much room on the bench for the user. It has good simplicity of use and design.



This toaster is quite chunky looking and simple. But would work well and be easy for the user. It would be multifunctional because it could fit different types of toast and sizes. The rounded shape of the design makes it look more interesting but the colour of the toaster is plain and boring. The toaster would be quite efficient as it can fit more than one piece of toast in at once and wouldn't take up too much room on the bench.

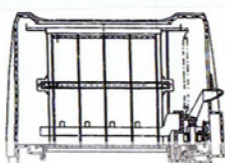

Design Development #1

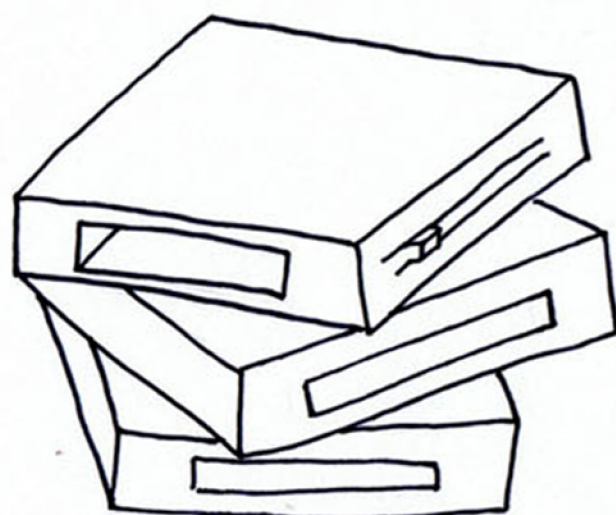

I chose to develop this idea further because there are a lot of possible changes that could be made and it is a different idea which could fit well in the modern kitchen.

Materials:



Plastic-



Metal-



- More easily moldable, than metal. It could also be more safe than metal as it doesn't conduct electricity as well as metal does.

- Metal has greater structural strength than plastic does. It is also more durable so can hold up for a longer length of time.

3

- For the materials of my toaster I have decided because of the reasons above to have a metal structure on the inside with a plastic overlay.

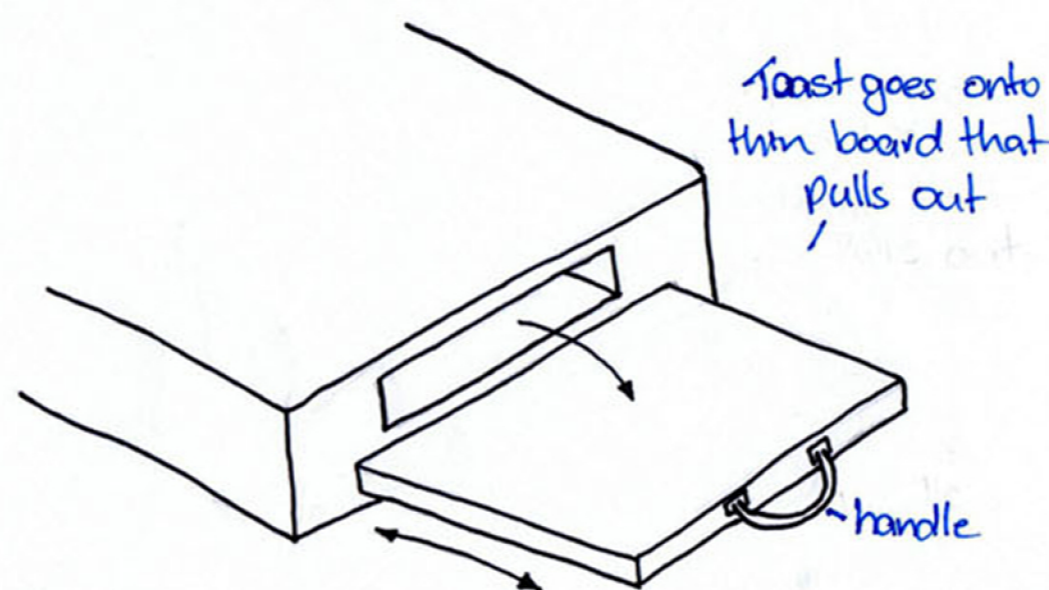
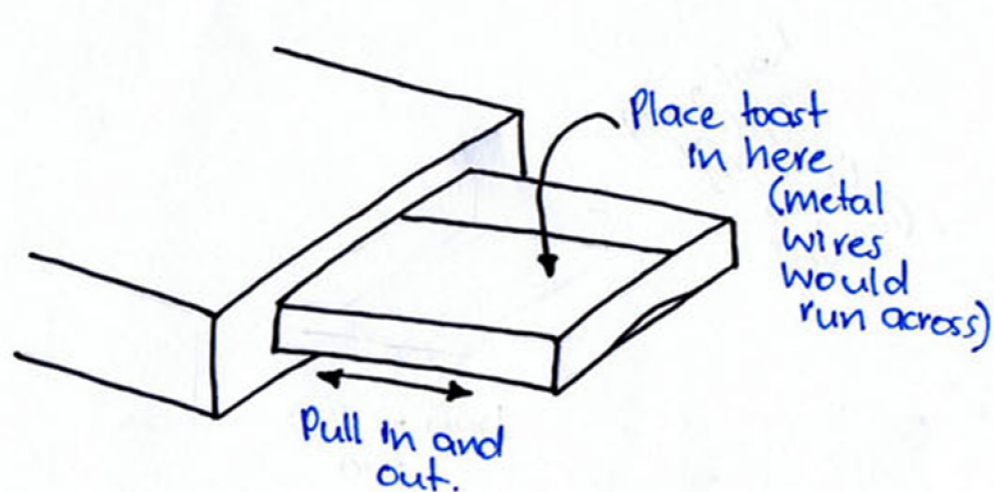
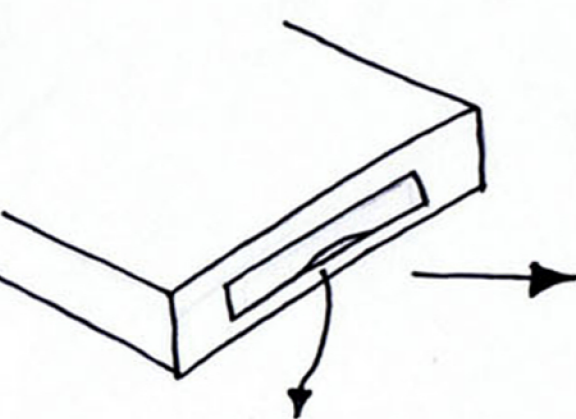

If I have an open slot with a normal slots that would pop out and possible that it would fall out of the toaster and land onto the floor. So it would need a tray that it could go onto or have it in a draw that pops out and the user could pull out and put the toast onto.

Initial Ideas

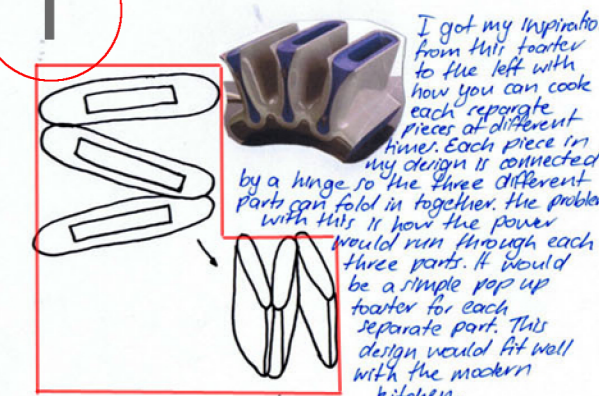
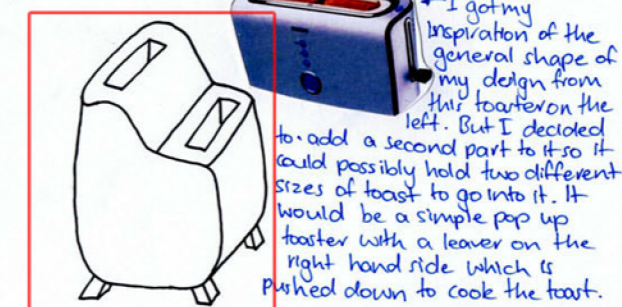
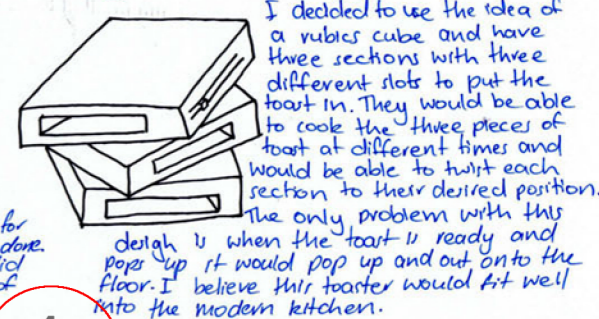
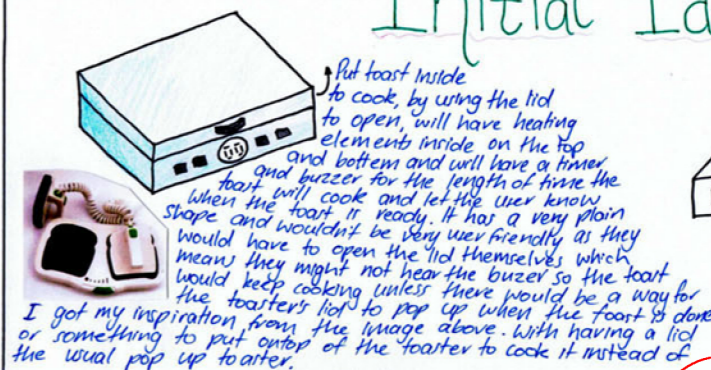

Initial Ideas #2

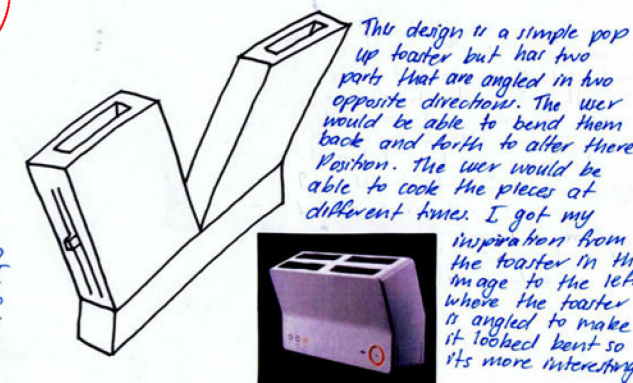
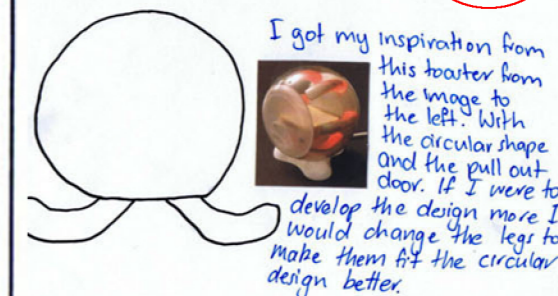
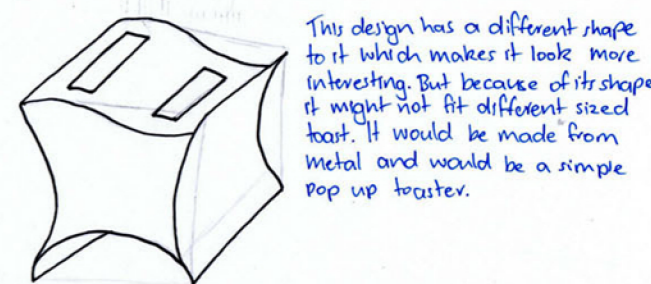
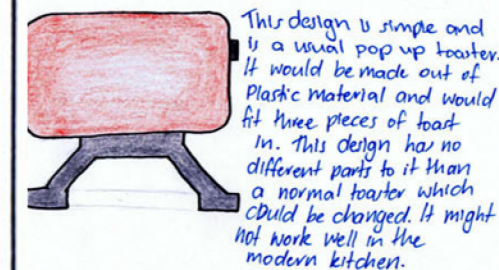

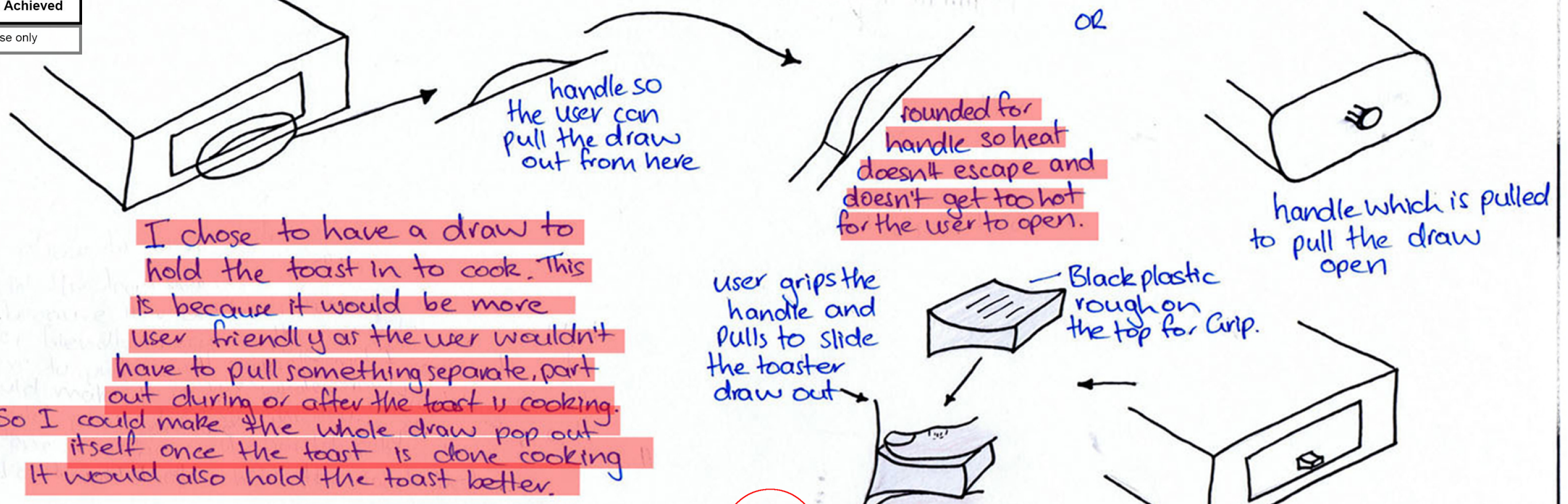

I chose to have a draw to hold the toast in to cook. This is because it would be more user friendly as the user wouldn't have to pull something separate part out during or after the toast is cooking. So I could make the whole draw pop out itself once the toast is done cooking. It would also hold the toast better.

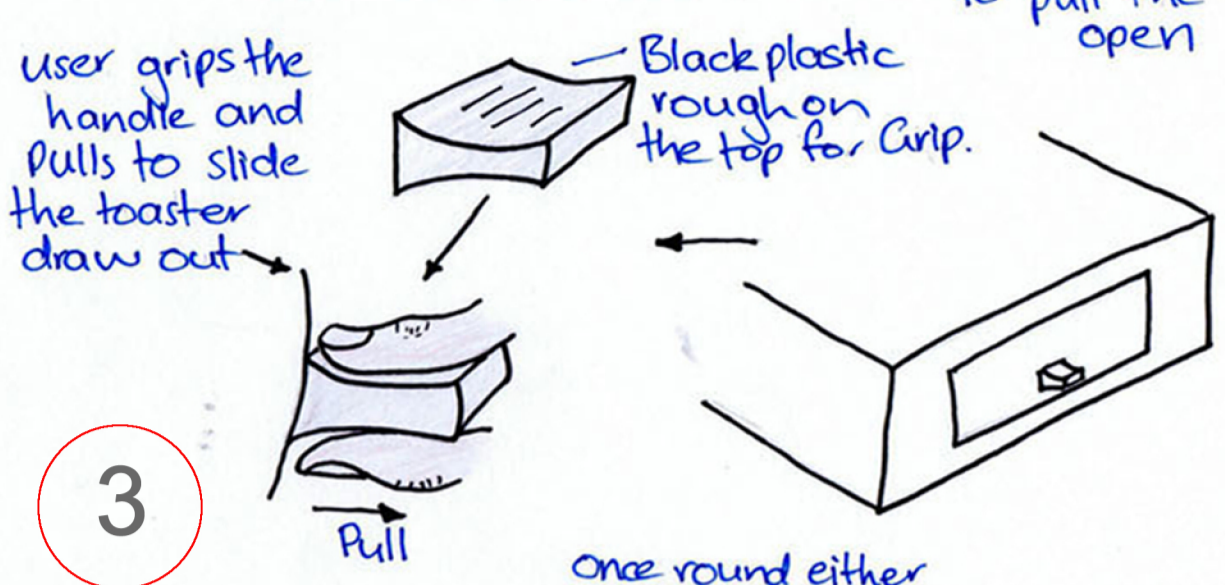

3

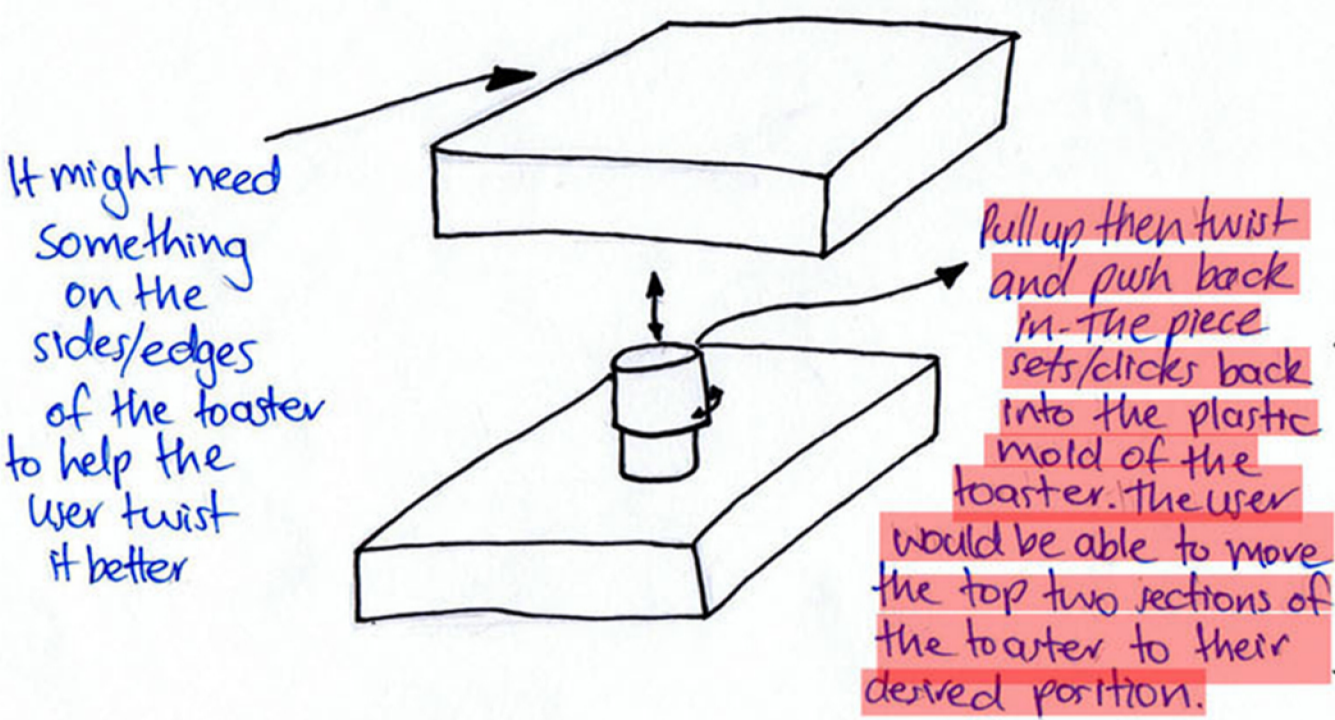

It won't be able to have the sections twist all the way around because it would have wires running through the middle sections running through the middle piece.

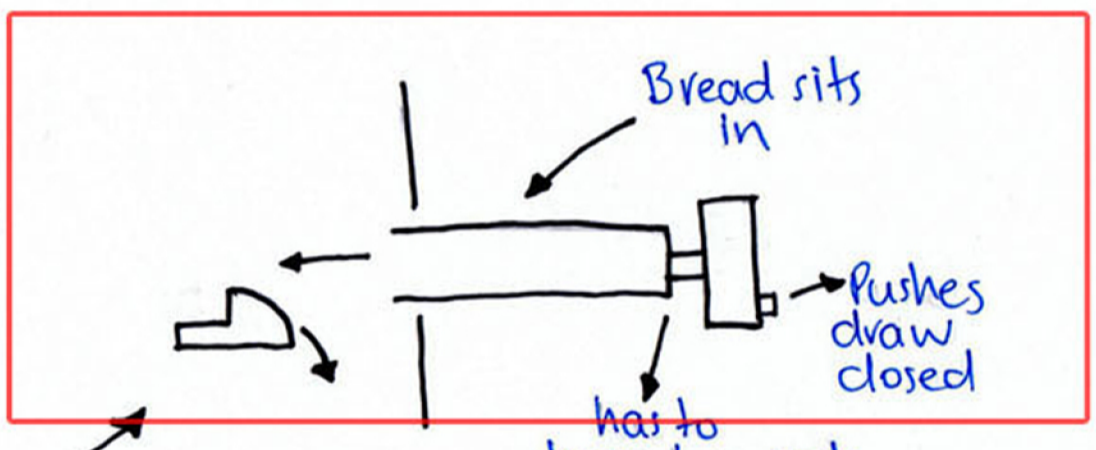
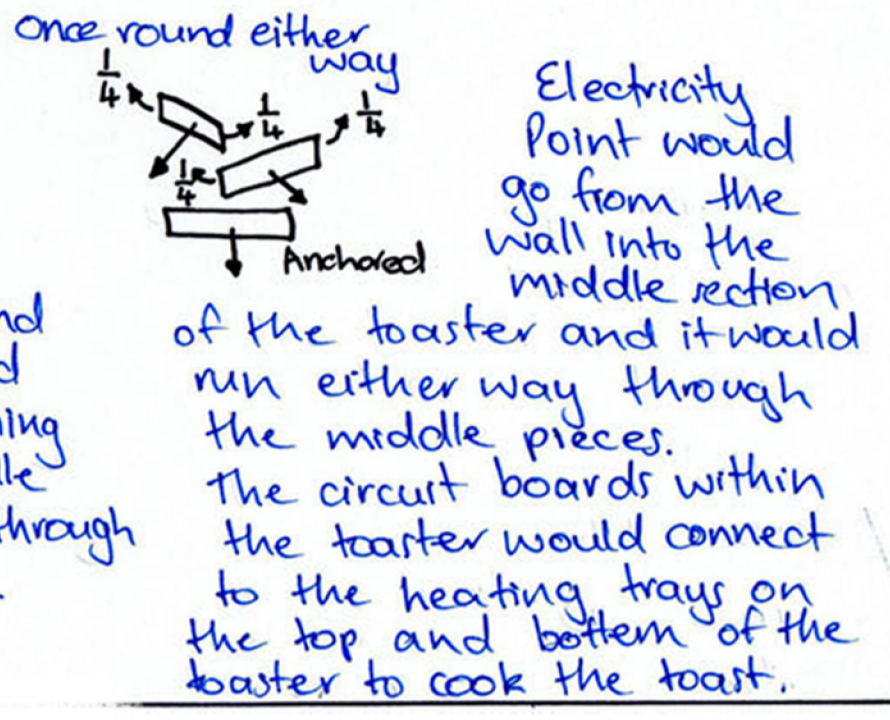

The draw runs over the lever until the first part gets clicked in place

4

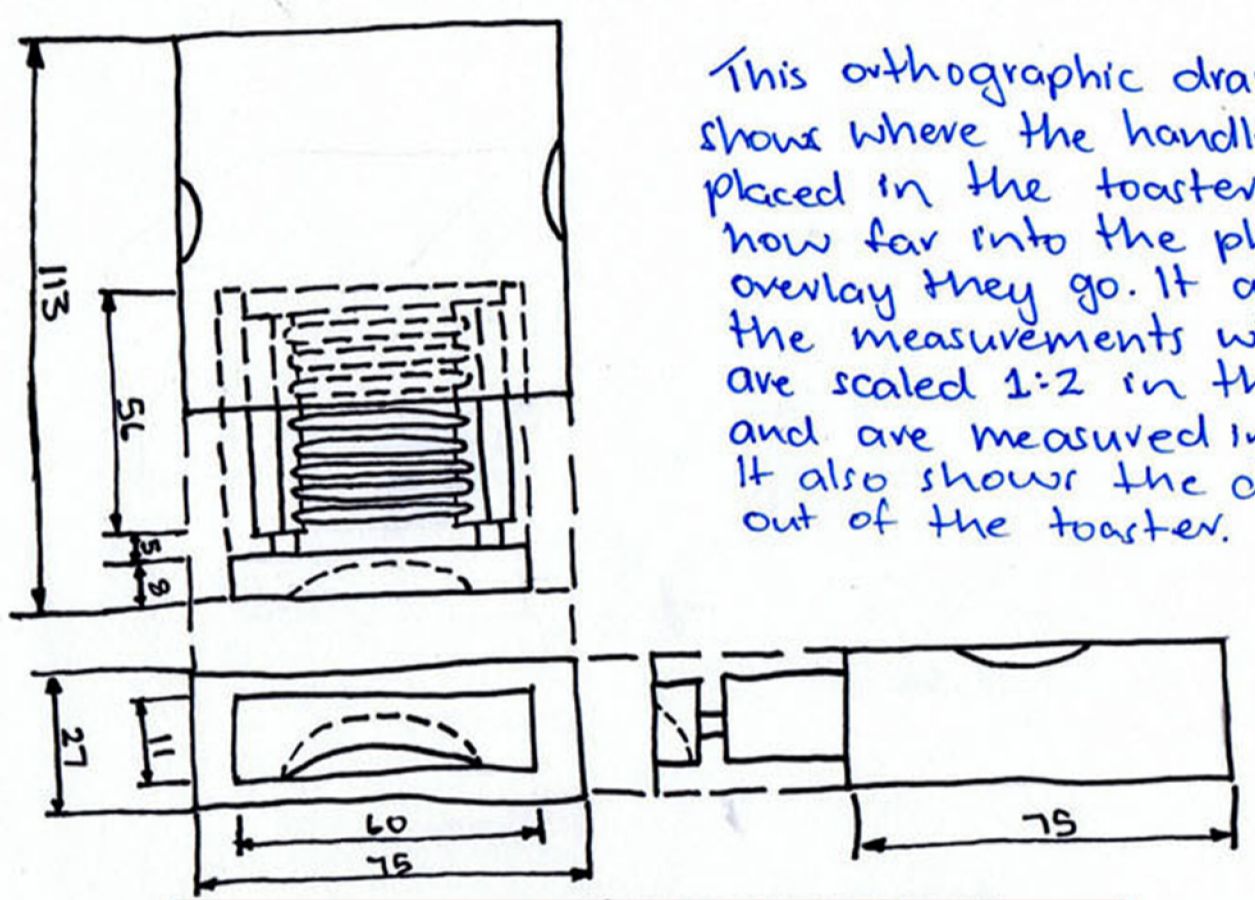
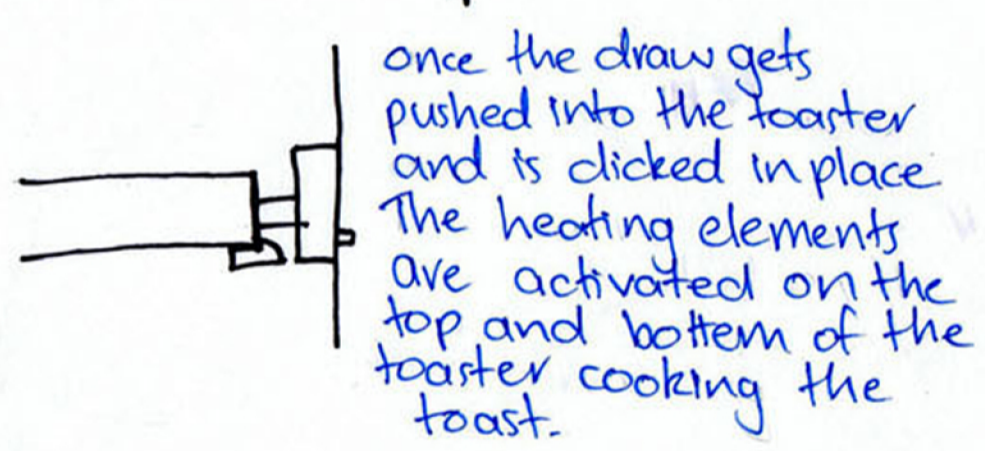

This orthographic drawing shows where the handles are placed in the toaster and how far into the plastic overlay they go. It also shows the measurements which are scaled 1:2 in this drawing and are measured in mm. It also shows the draw half out of the toaster.

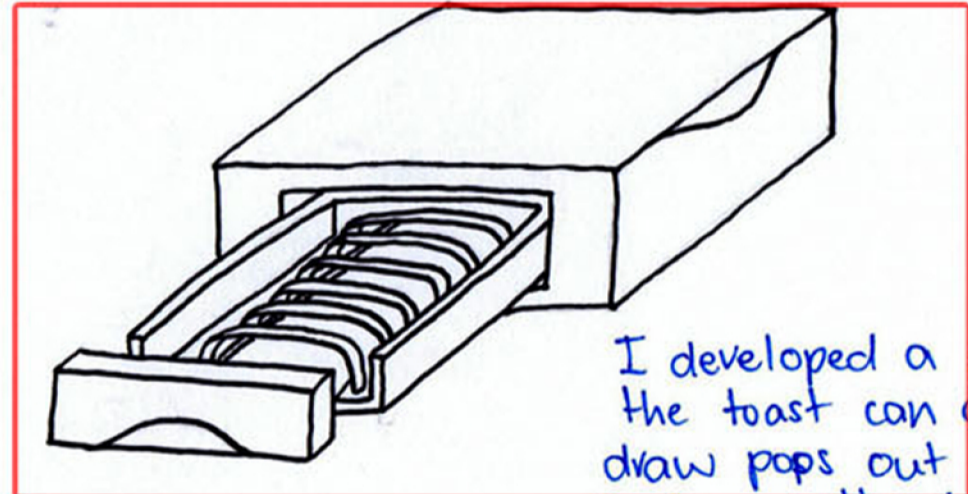

In my final design, compared to my original I have developed a draw that the user can open and have the toast cooked in. I designed handles for the draws as well as handles on the side of the top and middle sections so the user can twist them to their desired position.

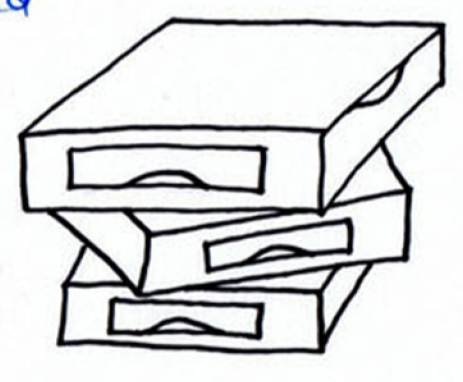

5

