

No part of the candidate's evidence in this exemplar material may be presented in an external assessment for the purpose of gaining an NZQA qualification or award.



Mana Tohu Mātauranga o Aotearoa
New Zealand Qualifications Authority

Level 3 Design and Visual Communication 2026

91627 Initiate design ideas through exploration

SAMPLE EXEMPLAR – EXCELLENCE

Wenderholm

Regional park
Cliff site experience

Site: air site

Experience: create an experience that replicates birds and the feeling of flying up in the sky / eyes of an bird. Perfect spot to watch the nature around you and a rest site while having information of the birds at wenderholm

Inspiration: birds



Wenderholm Regional Park



Wenderholm was the first ever national park to be open in New Zealand publicly in 1965, and is covered with rich wildlife and forests. The cliff side remains in the east side of the park.



The site requires a track uphill, which takes about ~40 minutes. The track includes stairs up a palm forest, and the sun sets on the ocean view.

Cliff site



Site from the beach

Site view



The site faces where the sun rises and has a vast view of the beach with plenty of nature and natural light

"eyes of the Bird"

air



FLY-CATCHER



Wanderholm park



FANTAIL



CRANE

Freedom



moodboard

Wing movement,
long beak

SECTION



Shigeru Ban



Zaha Hadid

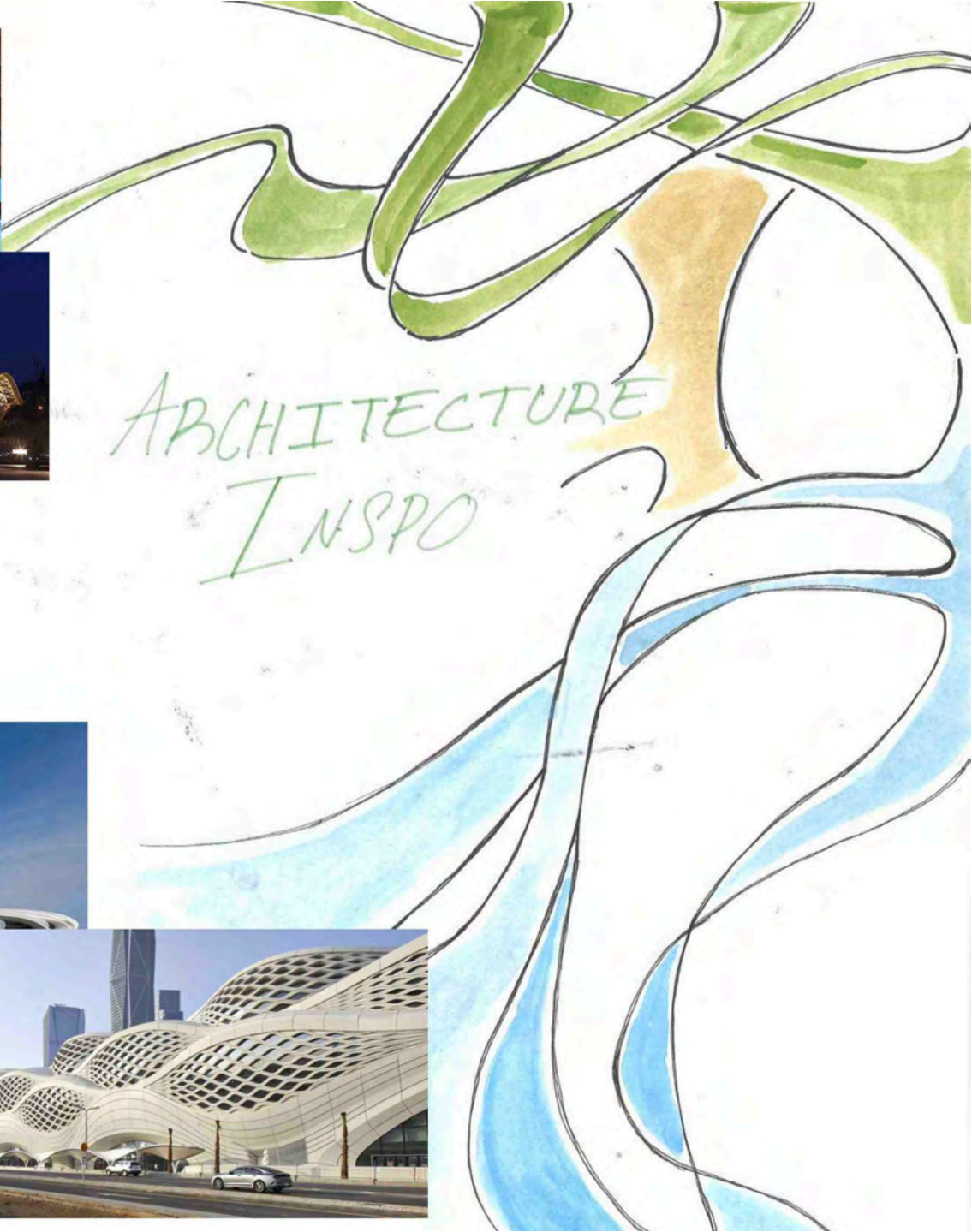
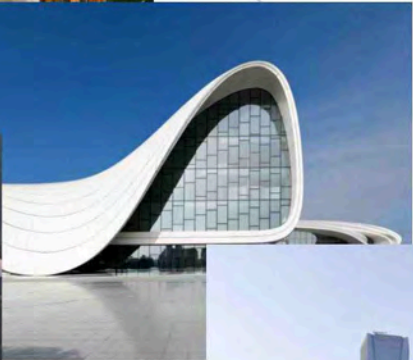

ARCHITECTURE
INSPO

air site

inspiration : birds

CRANE

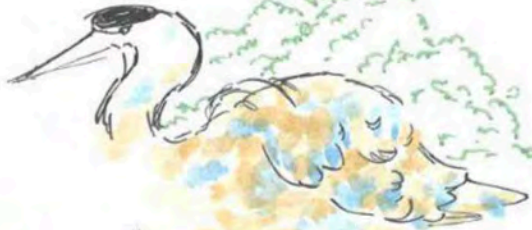

Winged

IDEA GENERATION

"Eyes of the bird"



layers



OWL

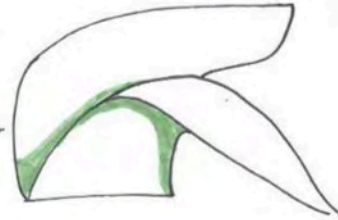

wuxi grand theatre

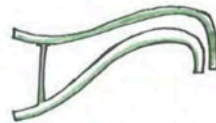
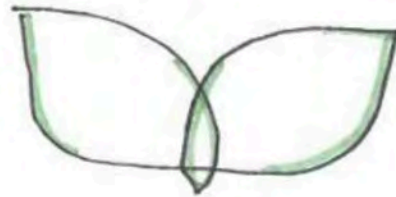
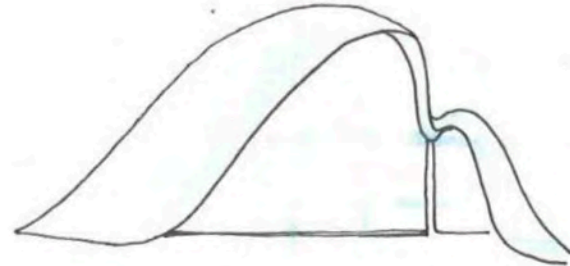
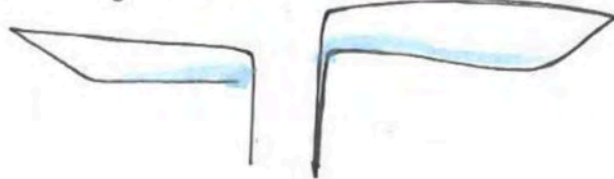

2 stories



Site is small —
How to fit Rest +
Info centre??

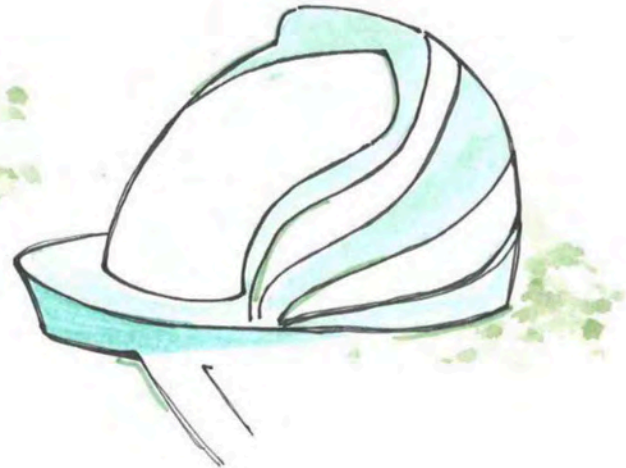
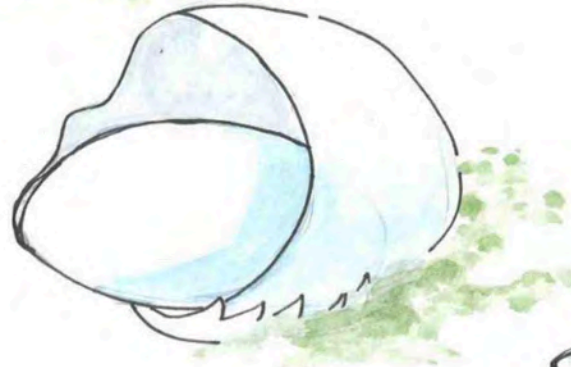
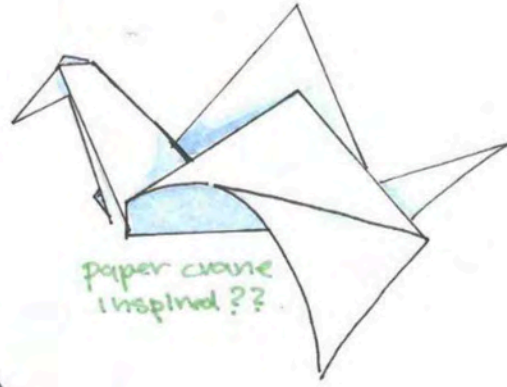
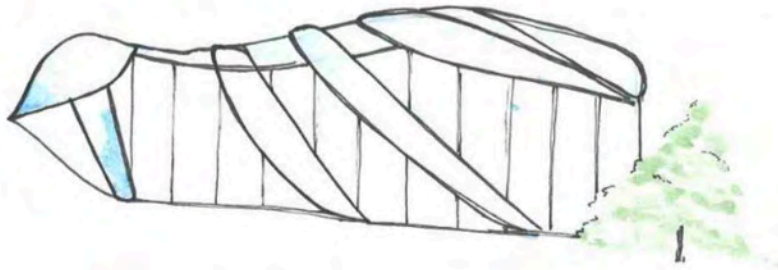

Exploration /
forming

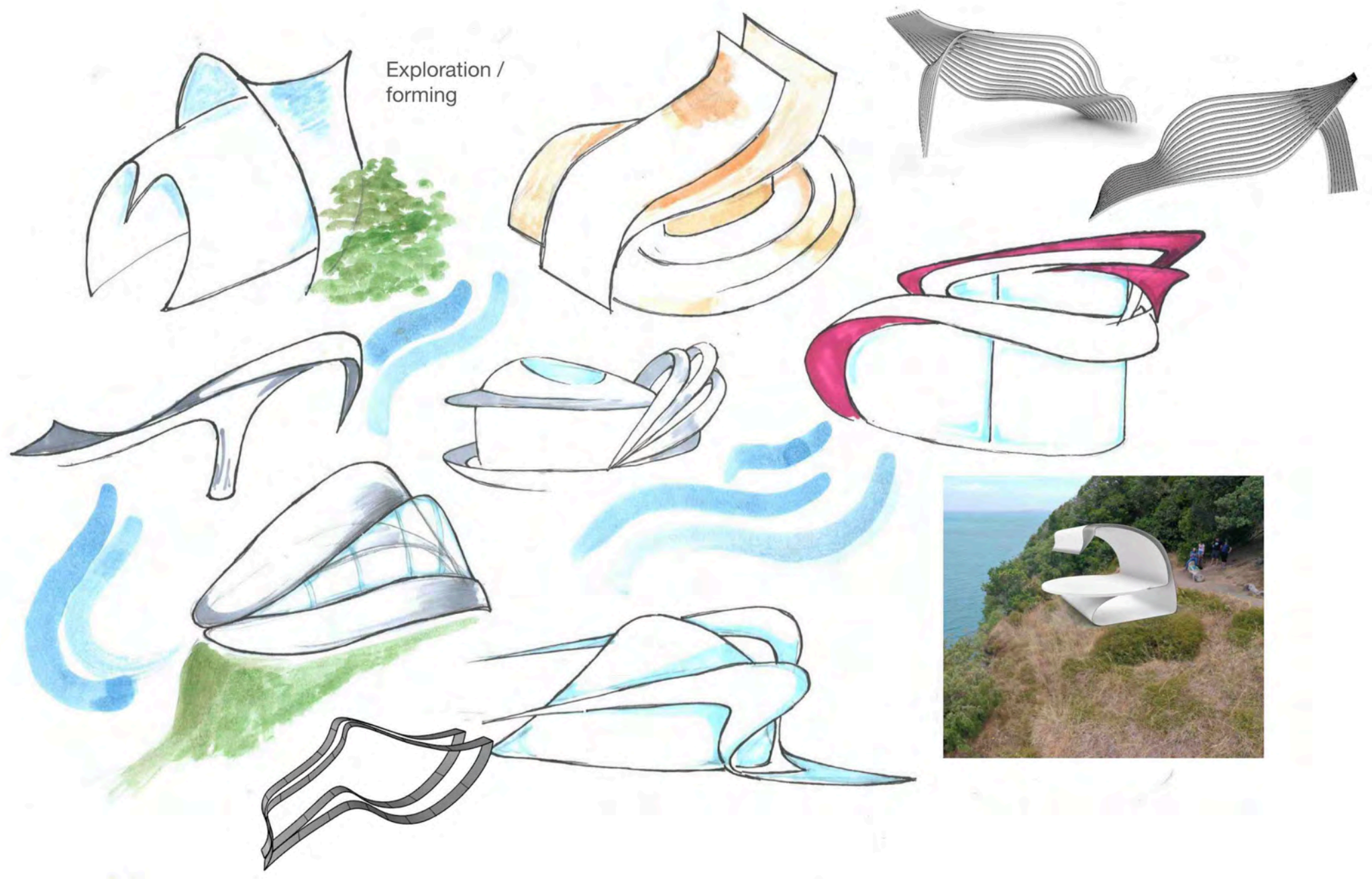

Extending

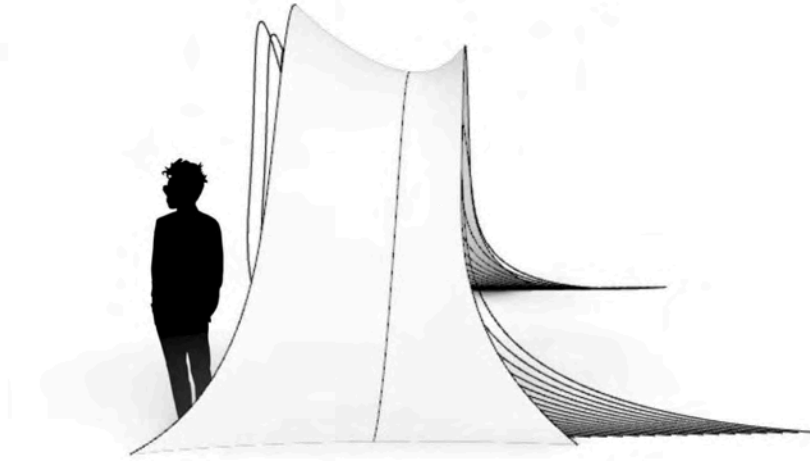
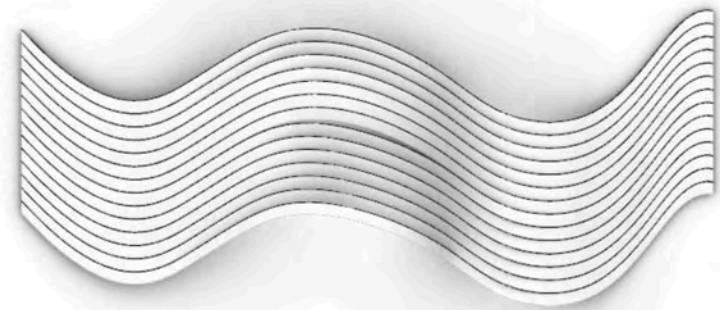
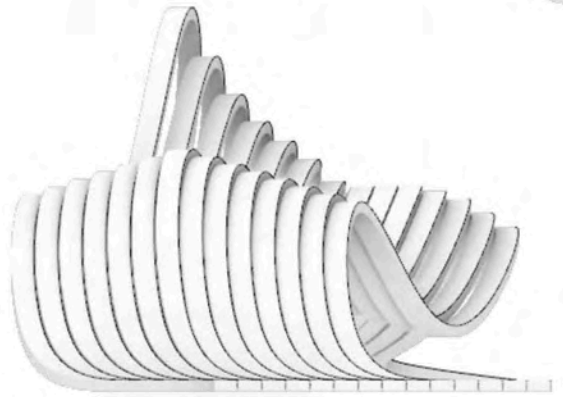
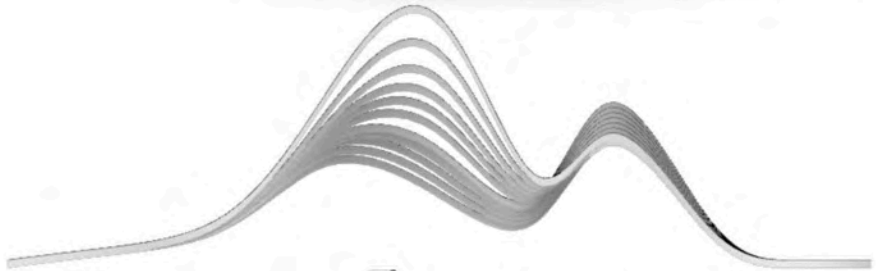

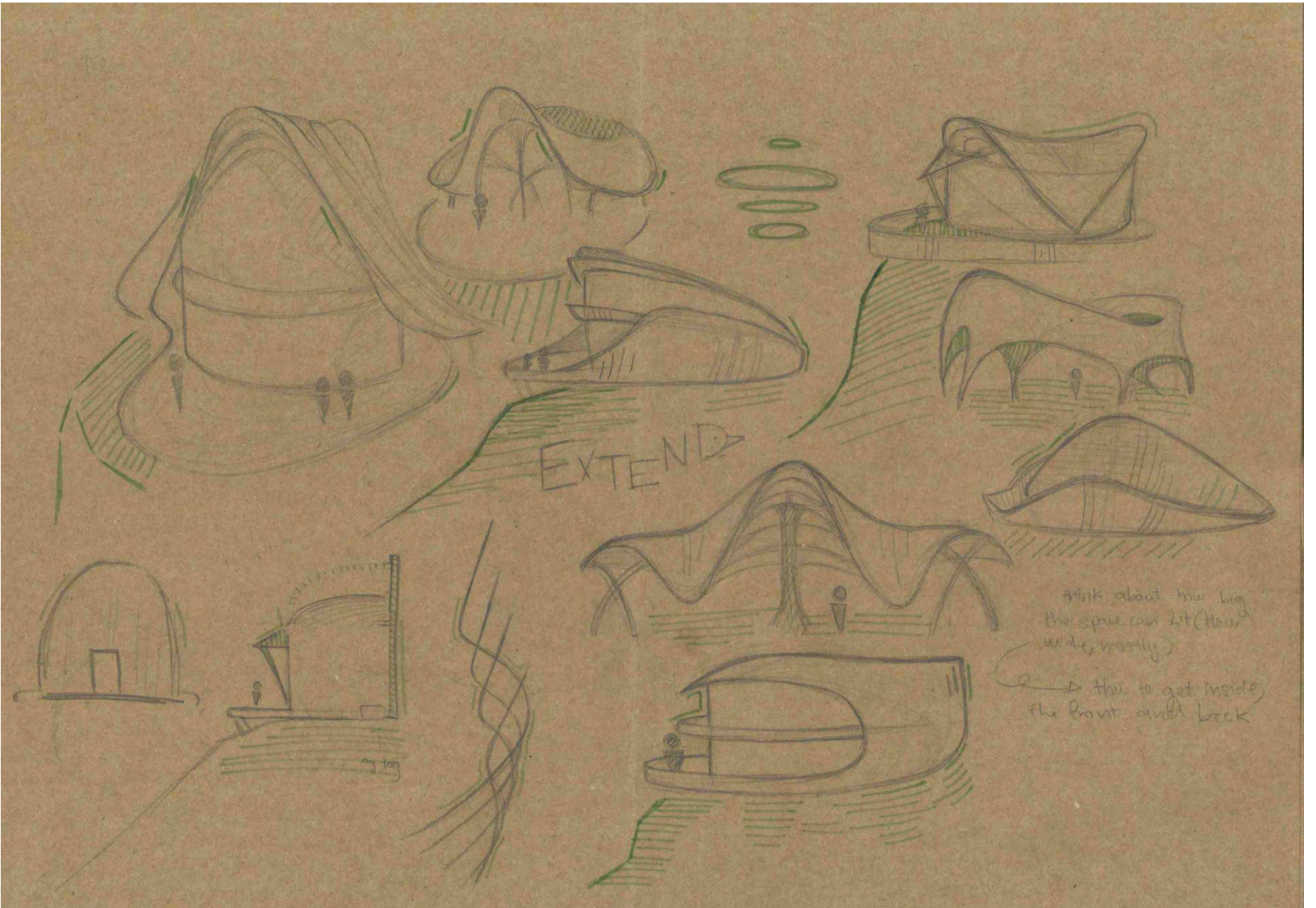

EXTEND

think about how high
the space can sit (floor
width, mostly)
→ how to get inside
the front and back

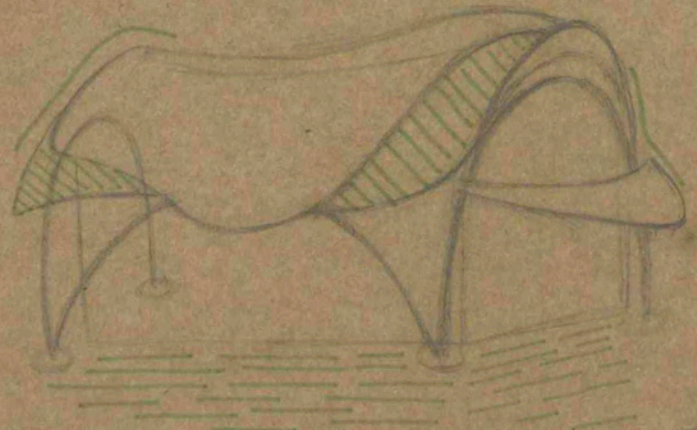

Extending towards a concept



different roof?

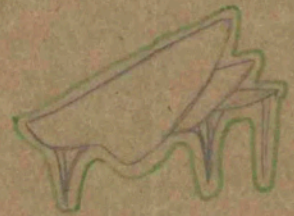

into 830

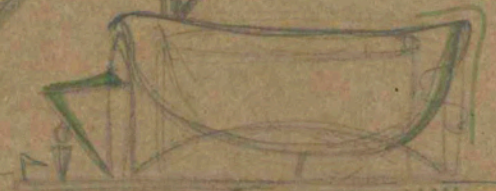

consider the size



instead of walls, open space

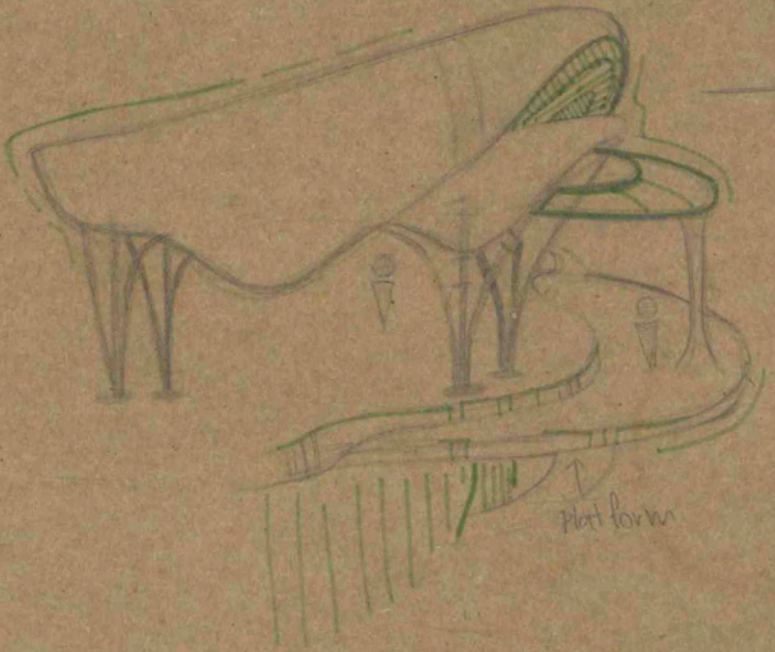

Plant form



wooden ring

Peoples experience

During the trail, you can see a great view of wenderholm. The site is a mid-way stop in the walk, and I do not want the site to be an obstructed view for passing walkers who want to experience the breathtaking breeze and view, if they do not want to go inside or just want to rest while also feeling the air. This is why I have decided to make my building open with no closed walls.

Purpose and place

Information centre about wenderholm and the birds and nature surrounding the cliff centre. A rest place for visitors after a tired walk, or a place to find shelter from sudden weather changes.

Overall architecture aesthetic

I'll be using pablo luna as my building inspiration, as their work has open walls and has has the bamboo aesthetic i would like to go with.



Resolve



Adding roof rafters to secure the roof, and to add a shigeru ban style.

→ add more rafters??

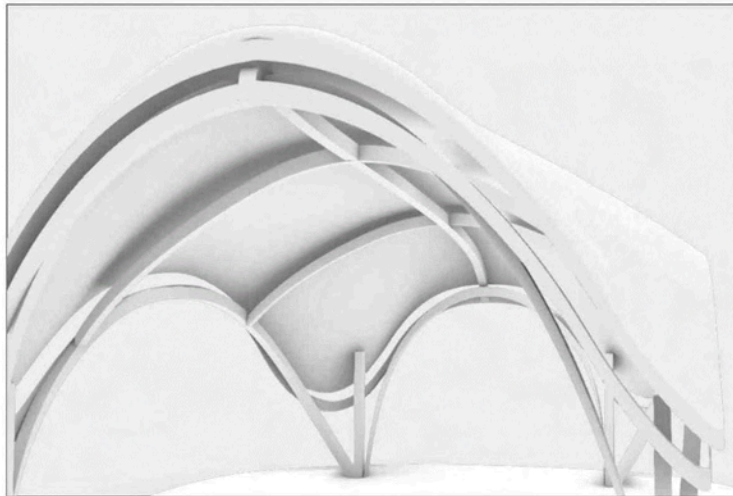
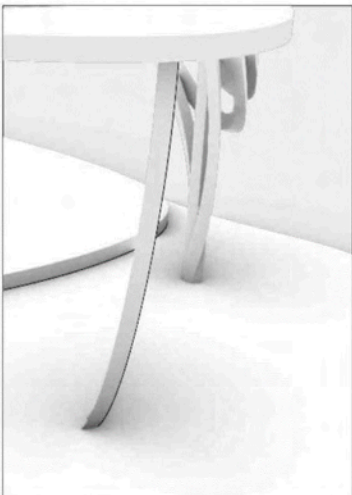

Added a extra overhead roof to imitate a beak.

→ consider if needed?

Curved flooring added

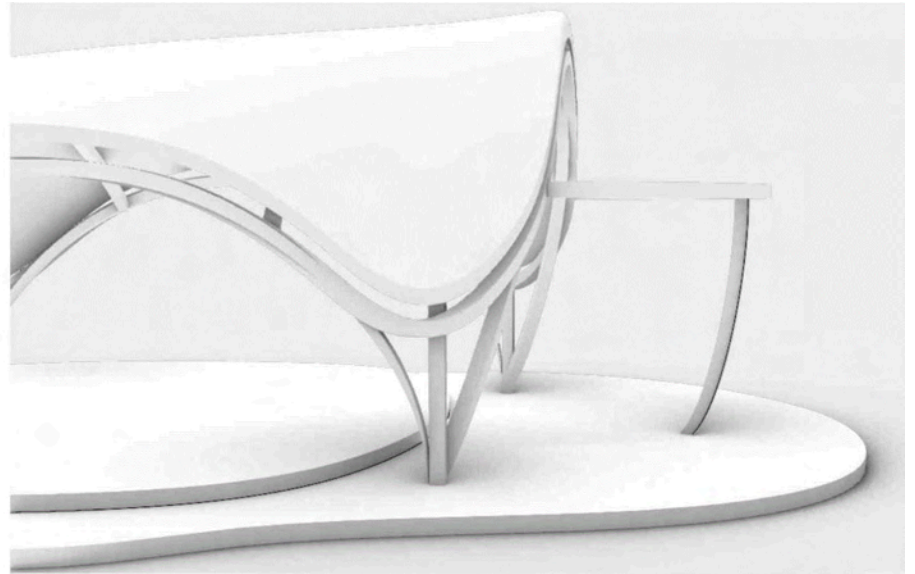

Added a more dynamic flooring plan, the current structure beams are rectangular

→ consider circular beams

Added cliff securing pipes.

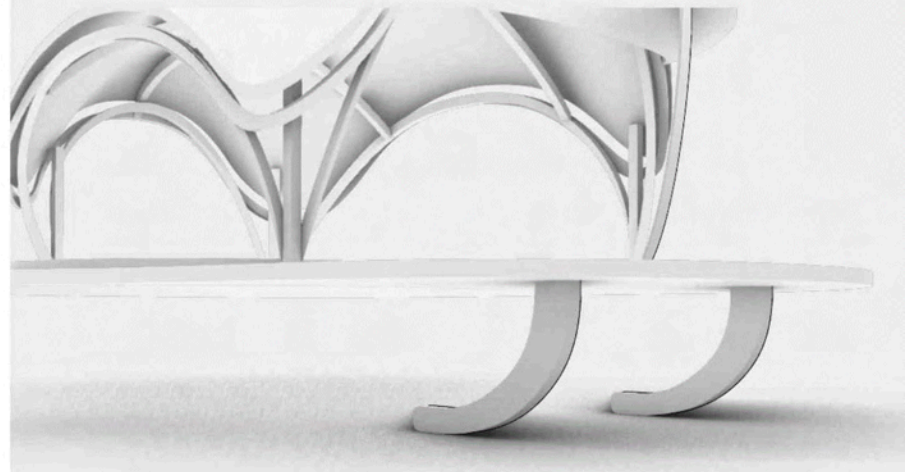



Added a railing to the edge over the cliff.
→ may change the design of the railing

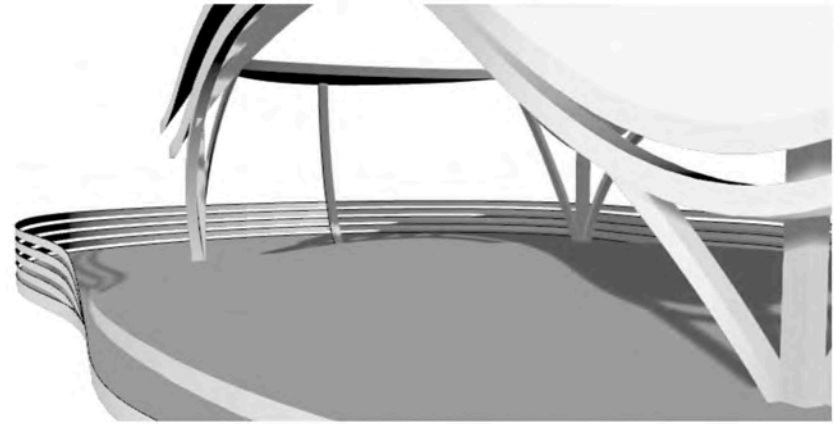

Changed the beams to replicate the bamboo structure that inspired me

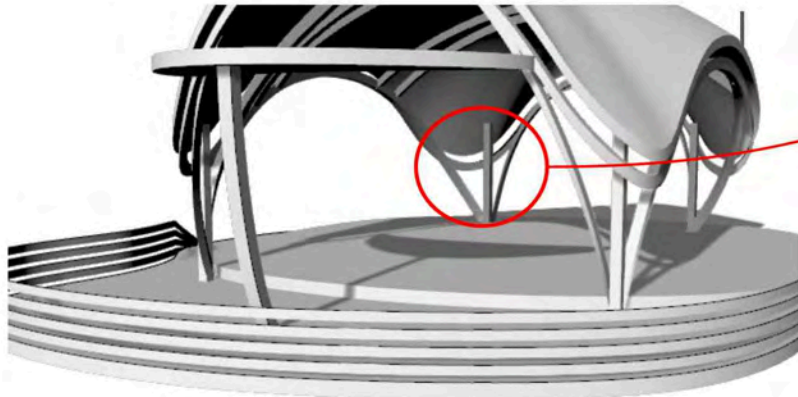

To ensure solid structure i change the middle pole to another arch supporting the roof

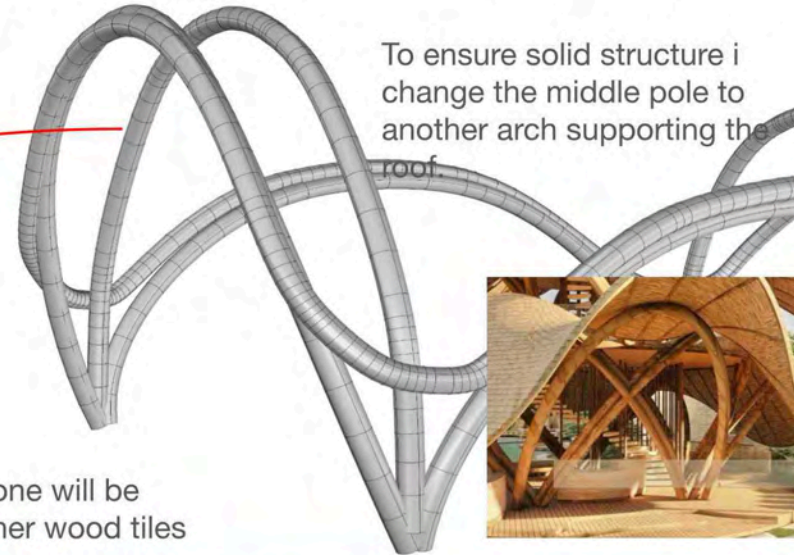

Added 'two' roofs, one will be bamboo and the other wood tiles

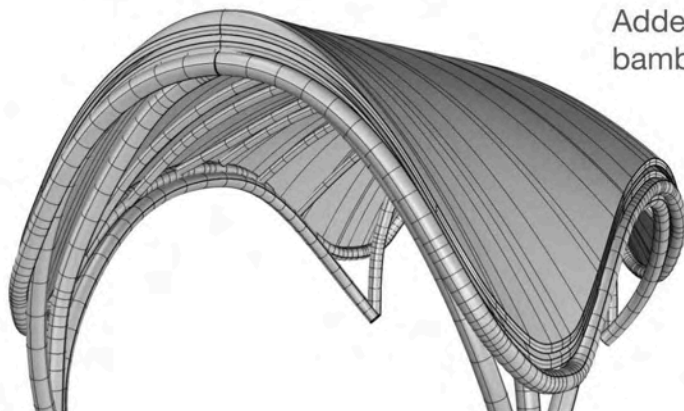

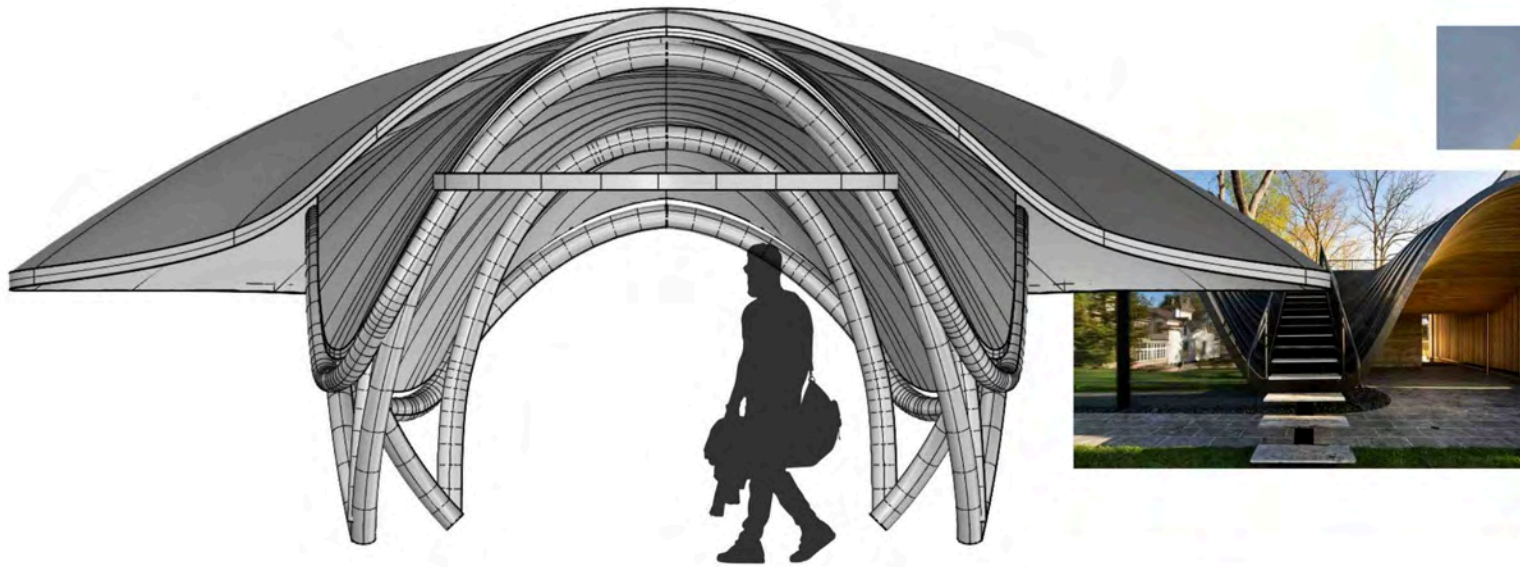

Added a side roof, for extra shelter and the for the wing of a bird aesthetic

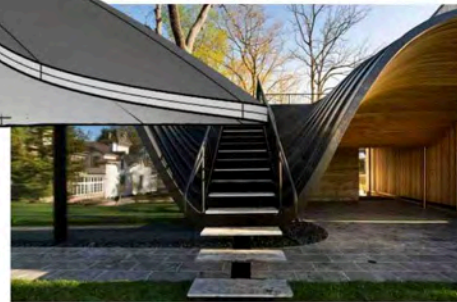

1st option, 3 poles, doesnt seem to help with the structure
Too thin

Playing around with the poles for the side roof/canopy



Same 3 poles with extra structure, seems to crowded, not a lot of space

More space, only 1 primary pole - chosen final



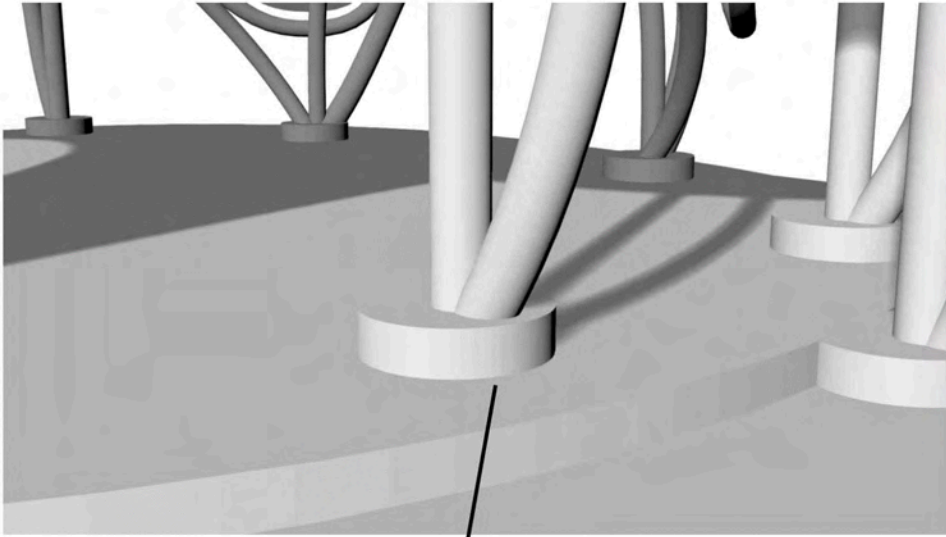

Adding a stone foundation to ensure the structures durability

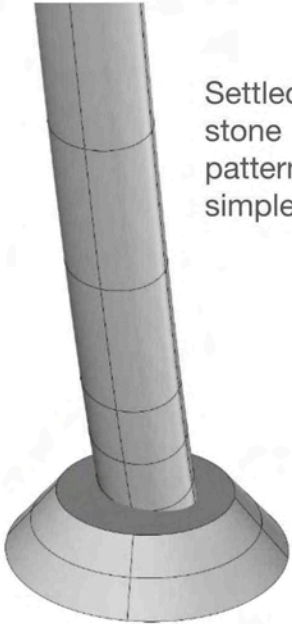
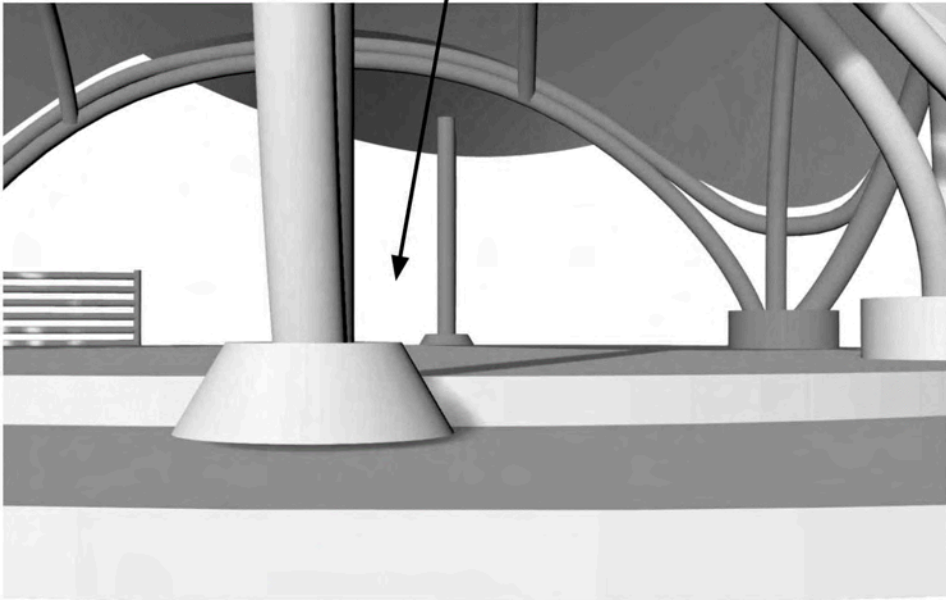

Settled for a stone with more pattern than a simple circle

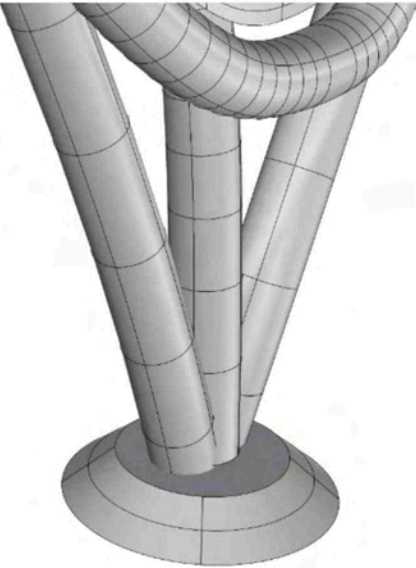

Railing – options

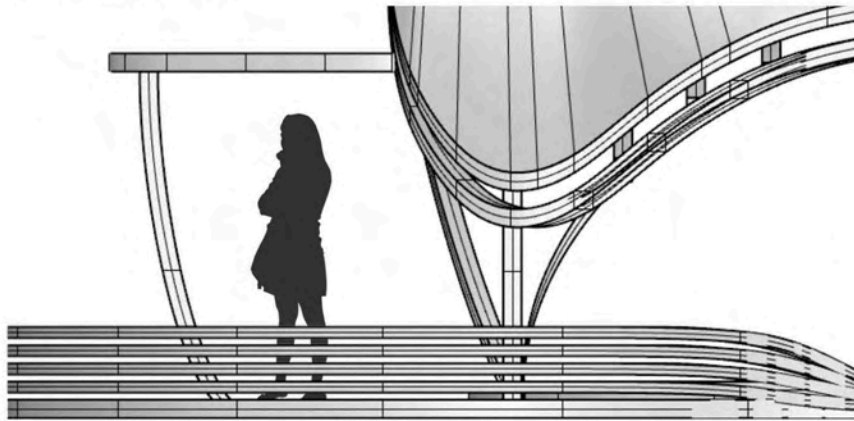

Originally wanted a metal fence, to have an accent as the rest of the building will be made up of bamboo/wood and will have a earthy feel to it. Wanted it to also have a wavy texture

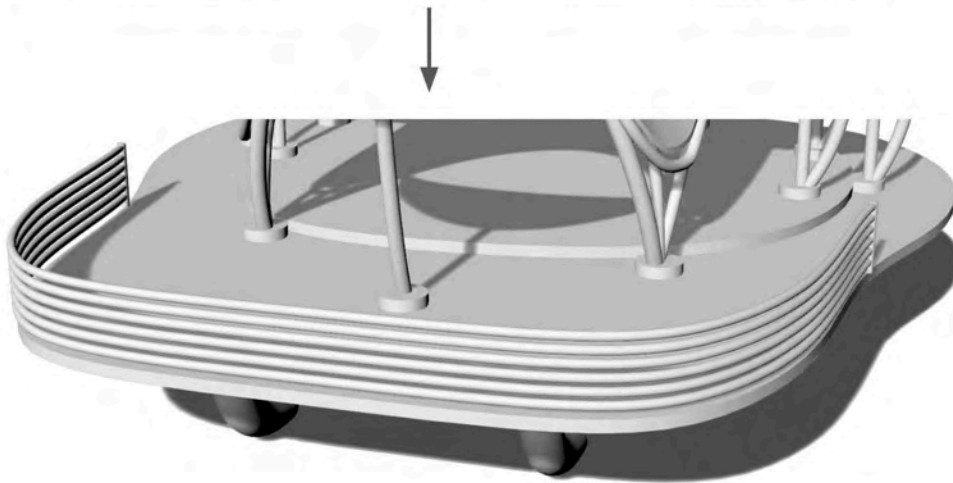

Changed to a simple and not complex fence, wooden and matching the aesthetic. Instead of rectangular, simply circled

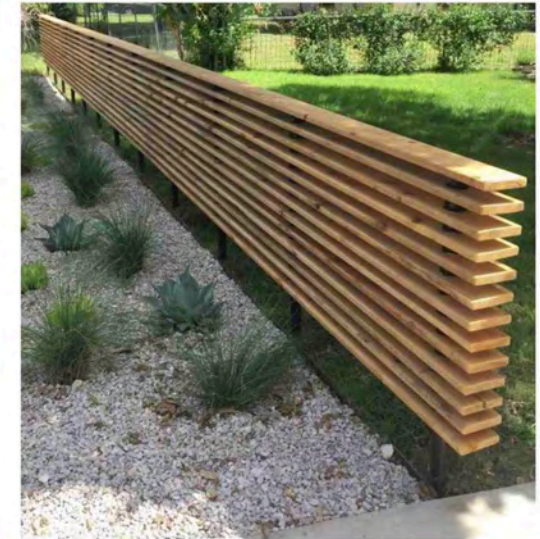

Extra details for the fence

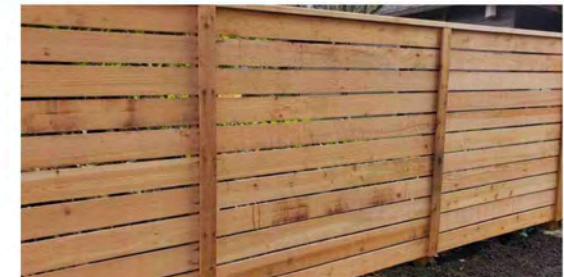
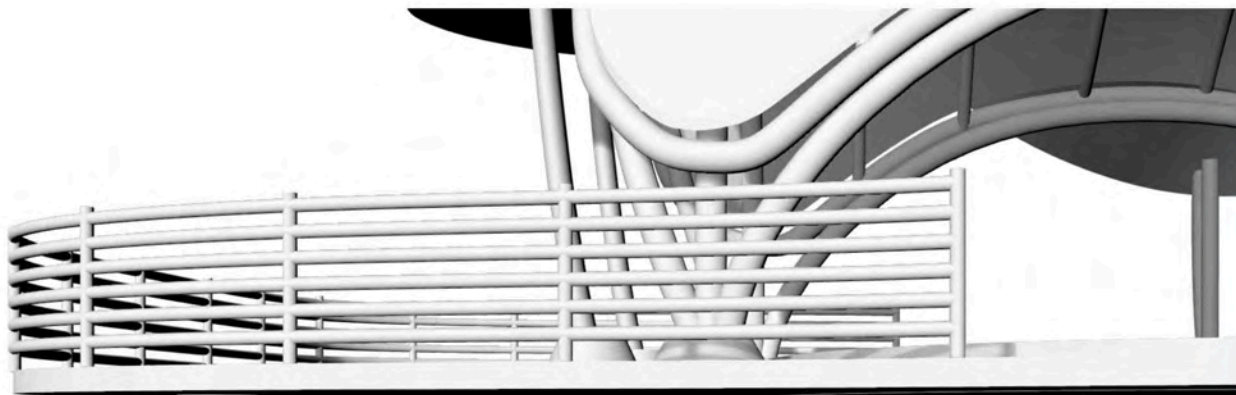

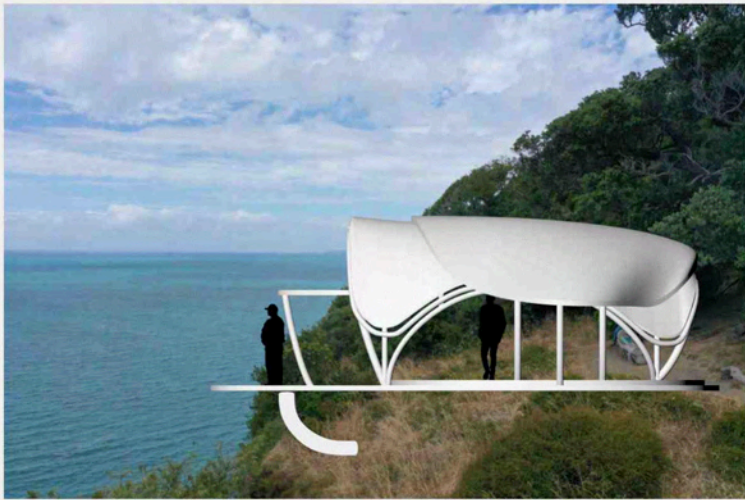

Added cliff supports, changed from rectangular to pipes. Added metal supports to connect to the mountain

Changed from a simple pole to 2 poles, to keep it more open as the original 1 pole was getting in the way. Looked way too crowded

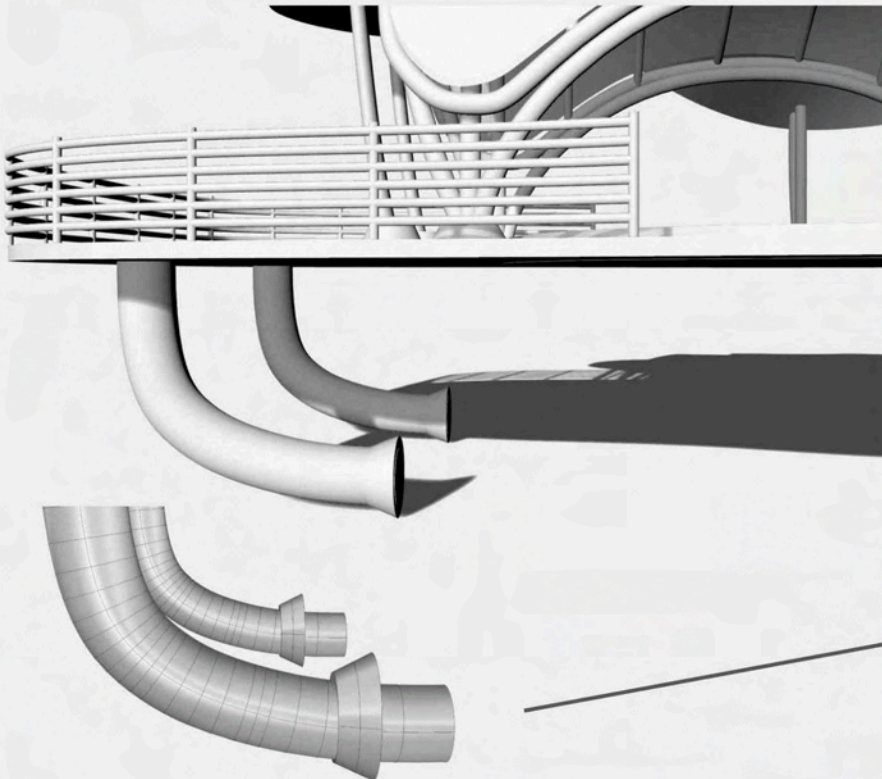
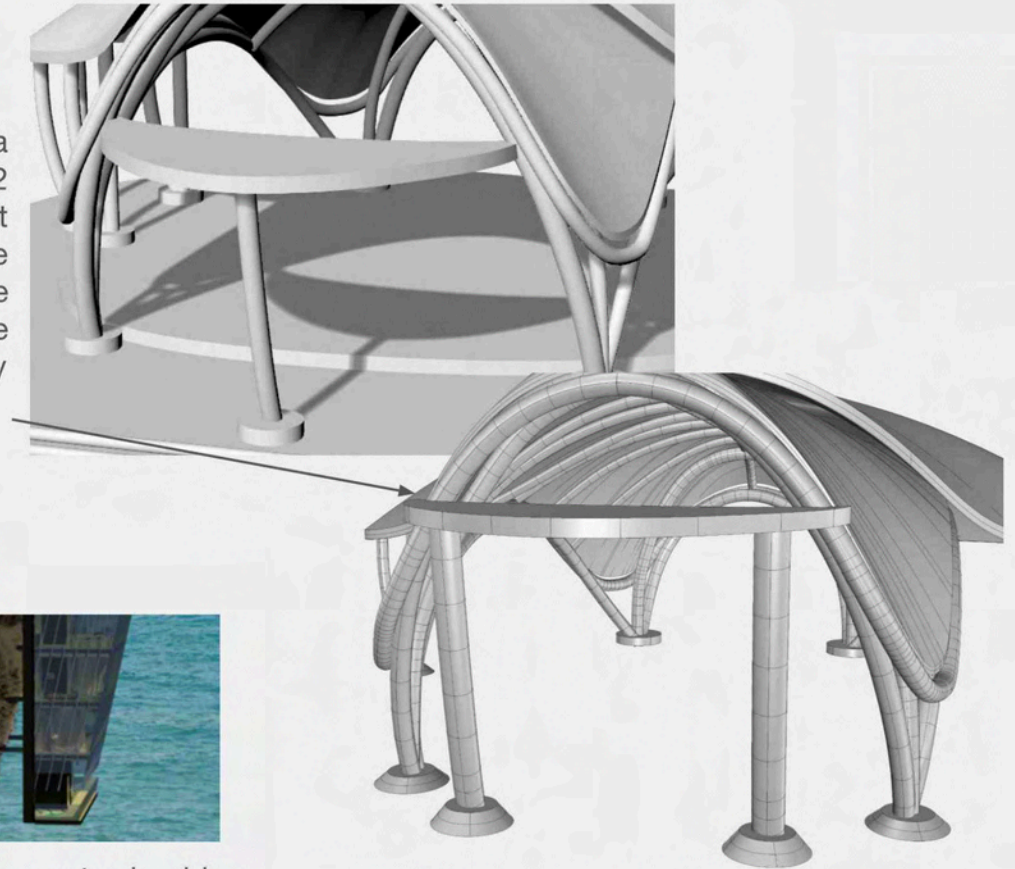

Metal supports should go through the mountain, to ensure the support over the cliff.

The pole will go through the mountain into it.

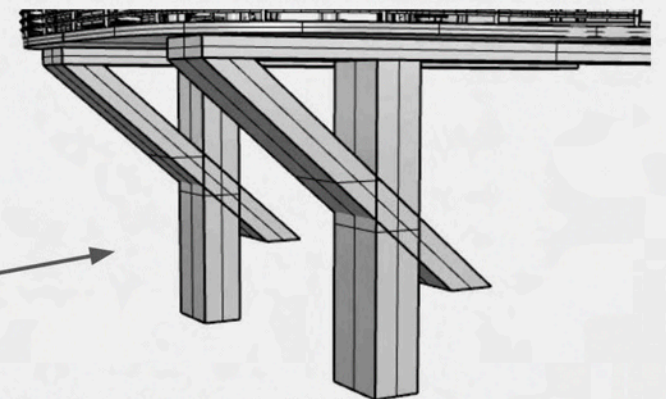

Changed support poles as curved didn't make sense,

1

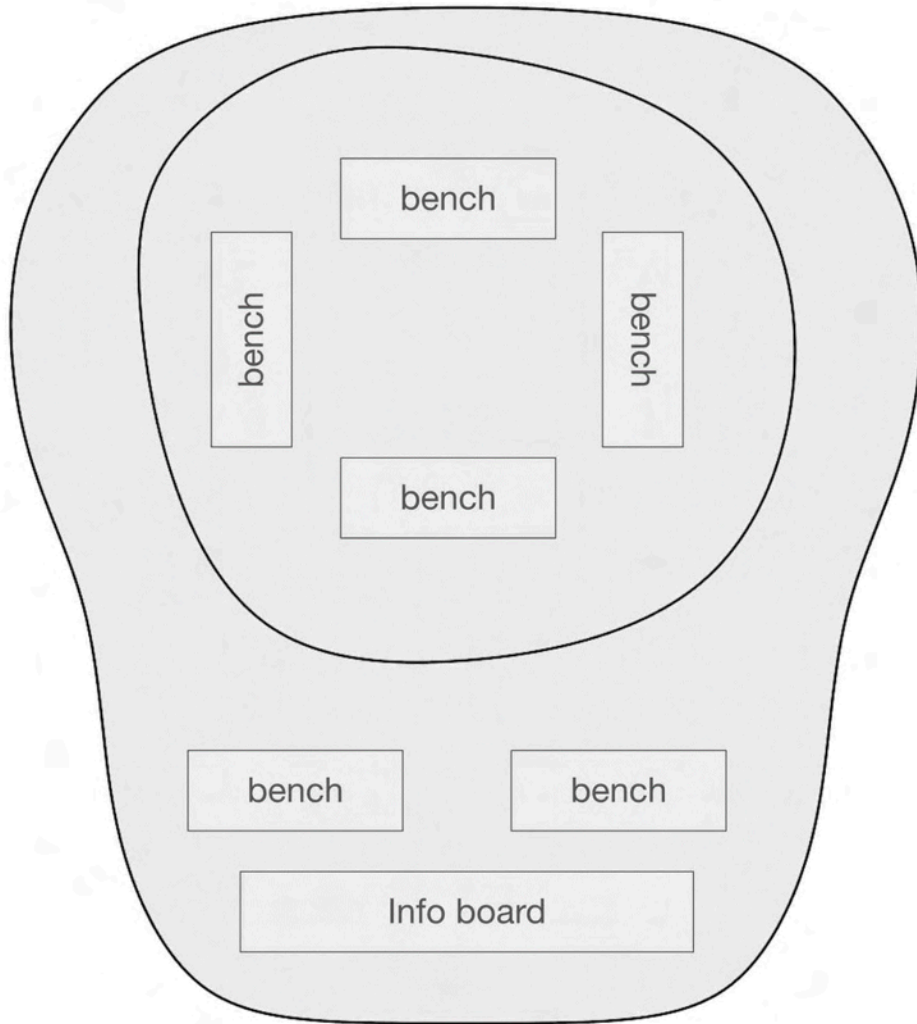

2

Make these boards transparent,
and place something in the
middle

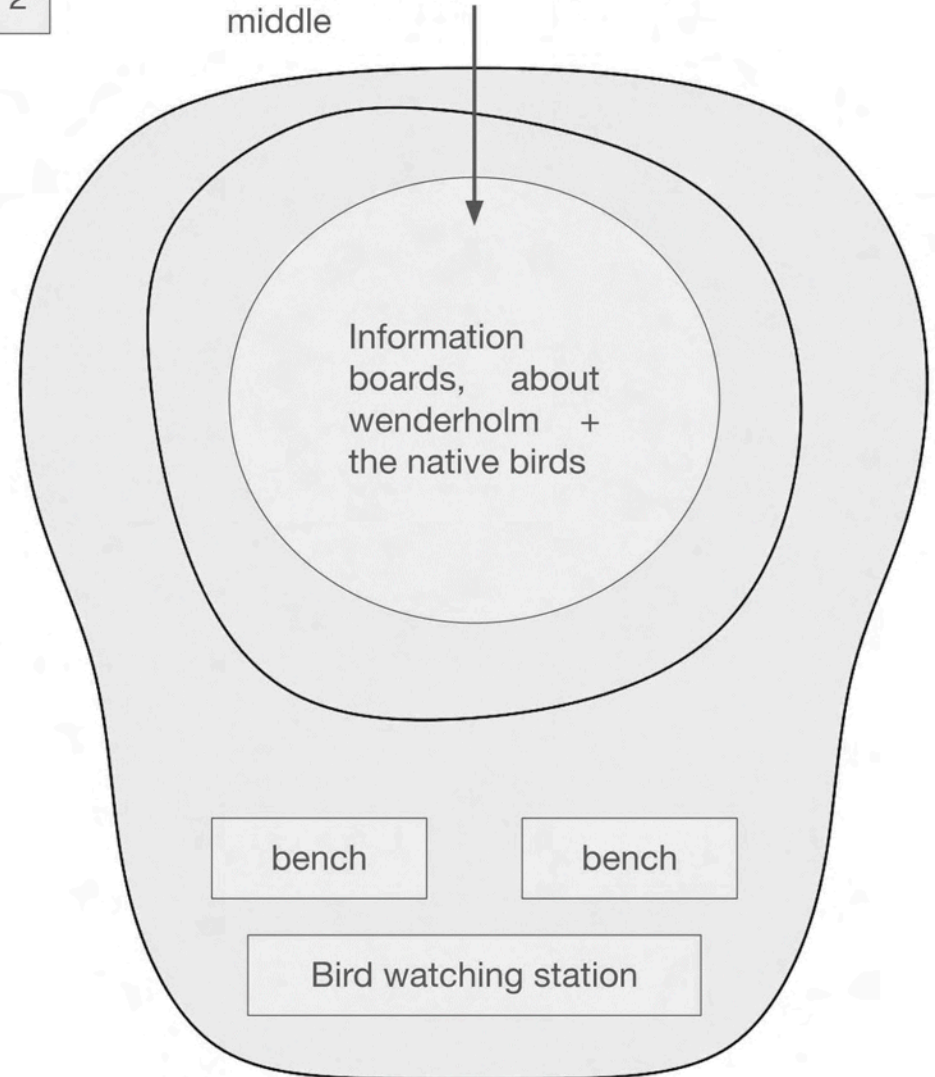

Use benches under shelter, and out
of shelter, for the user experience to
either take in the breeze or seek
shelter while watching the view

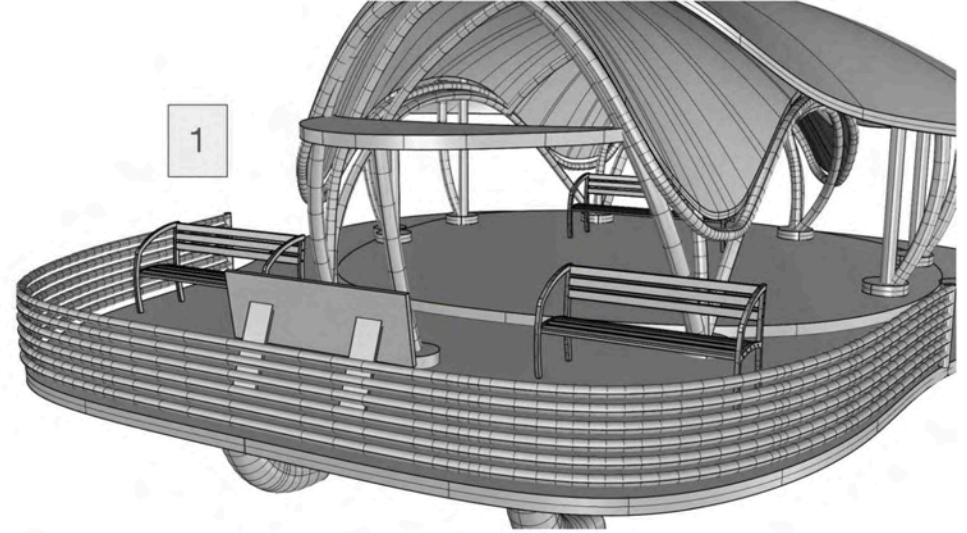
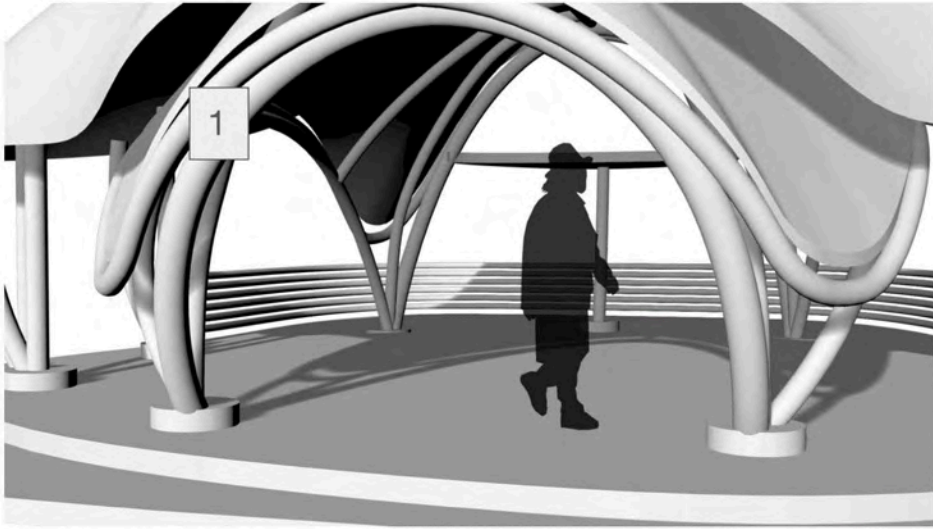

Resolve : interior

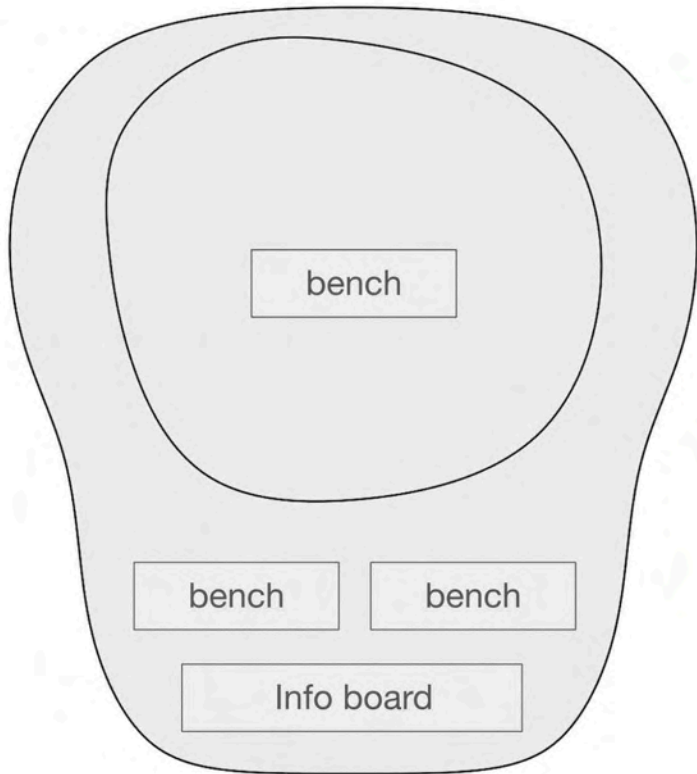

2



Roof rafters for more support, giving the pabloluna aesthetic.

Simple wooden benches and board.

→ may change to bird watching station (?)

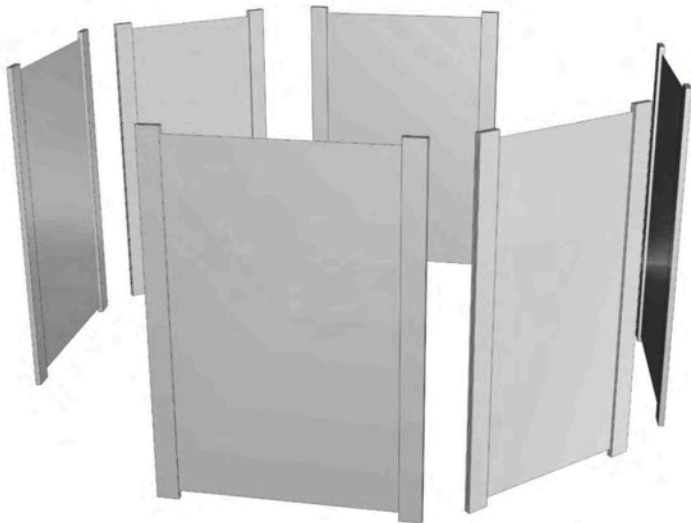

Te waikoropupu springs walk information board.

→ taking inspiration from the glass boards to display wenderholm information, guides, and the surrounding birds in wenderholm

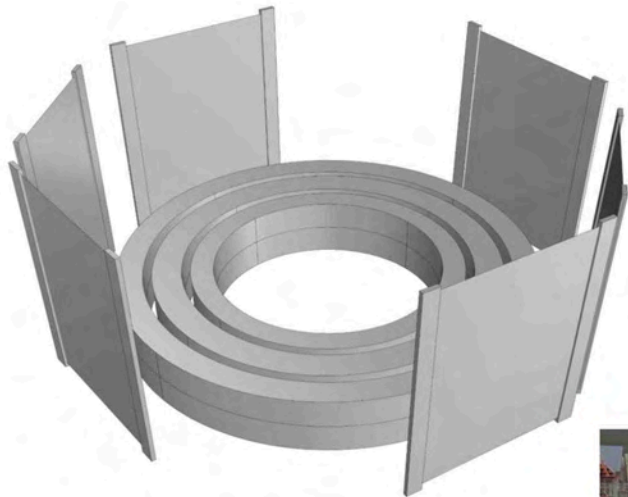

Added a circular bench inside the boards.

Cut in the middle of the floor to let in plants to add a more earthy feel.

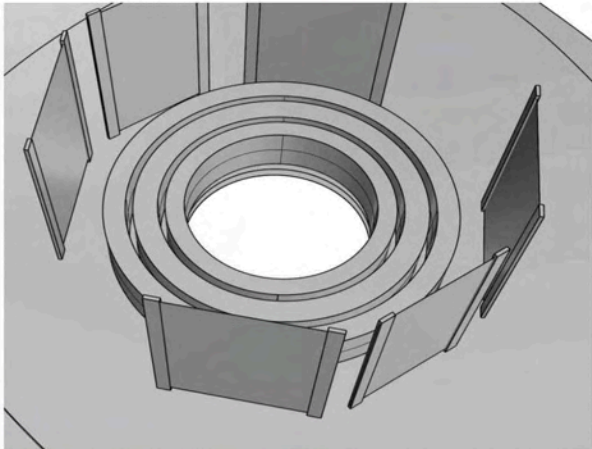

Added binoculars attached to the table for bird watching – board will be what birds you can spot

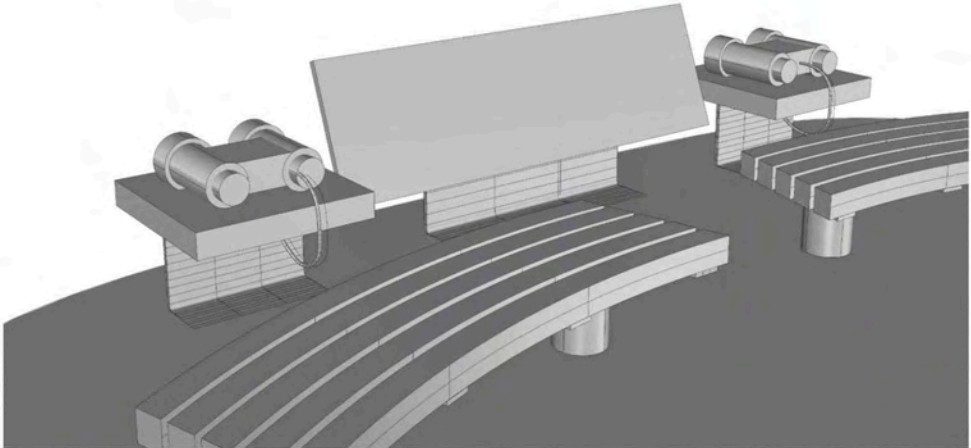

Final design for interior

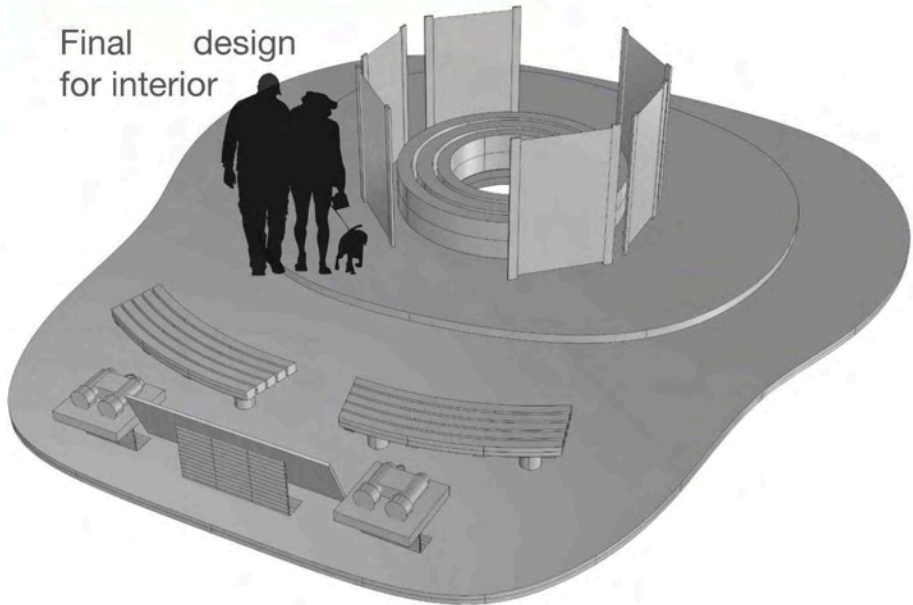

materials

1. Structure inspiration

- Bamboo, for the aesthetic and the structure of the building. Renewable and sustainable - while also versatile



2. Roof inspiration

- Inner roof: flattened bamboo roofing
- Outer roof: wood shingles

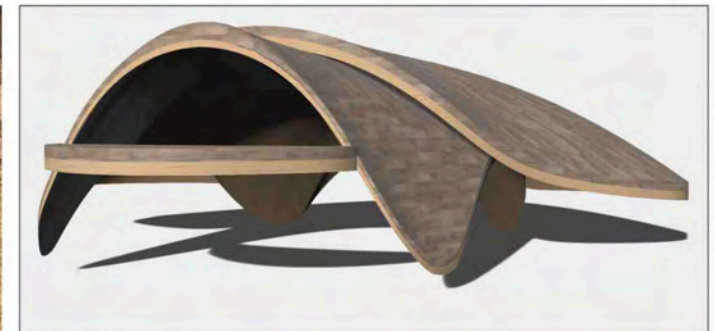

3. Flooring + foundations

- Natural soft stone

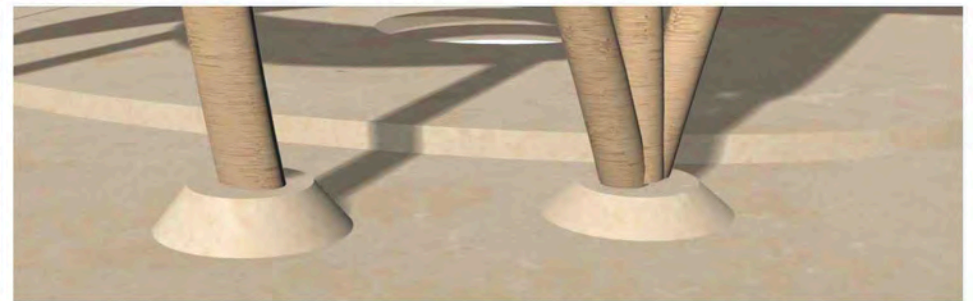

4. Cliff foundations

- Steel metal foundations to enforce the platform

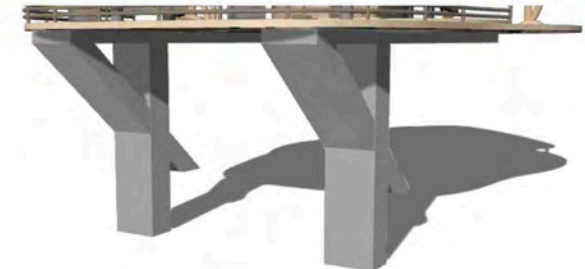

materials

5. Railing

- Timber railing

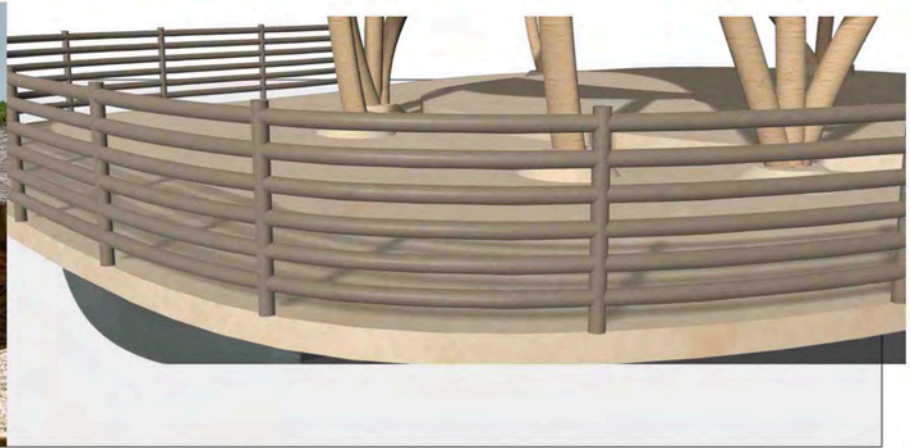

6. Interior

Stone stands, wood desks. (info board will have a info image over)

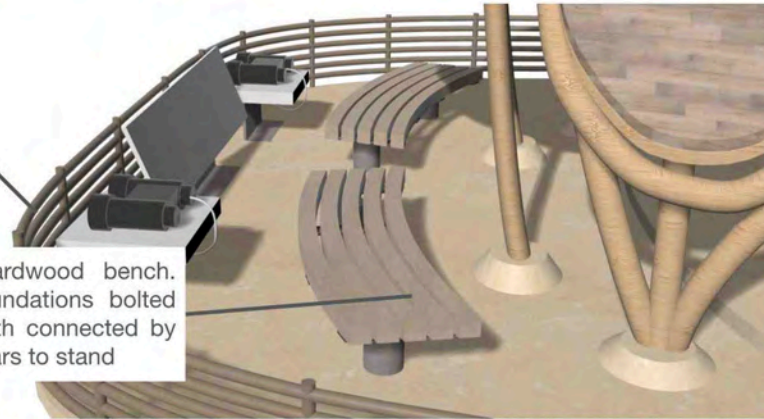

Cedar hardwood bench. Metal foundations bolted underneath connected by stone pillars to stand

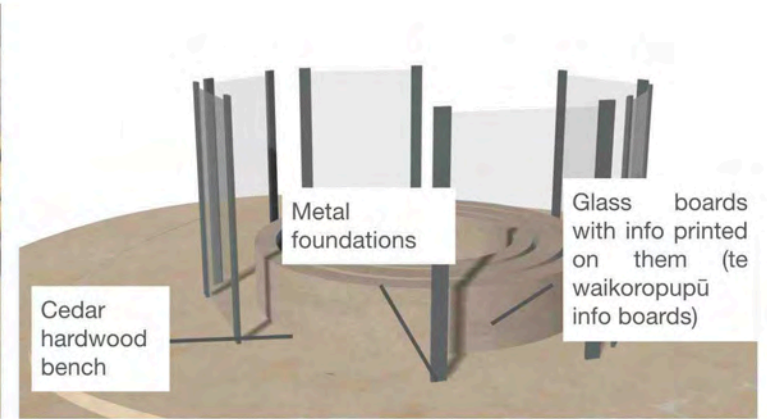

Metal foundations

Glass boards with info printed on them (te waikoropupū info boards)

Cedar hardwood bench

Final details

To make sure the bamboo structure is secure, long thread bolts were added with steel cables. Used to connect the joints in the bamboo architecture

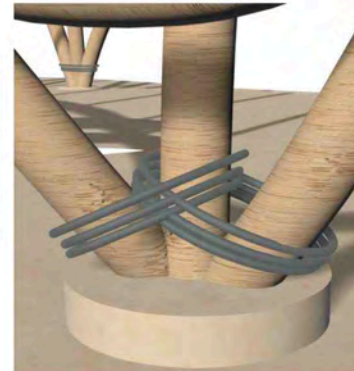
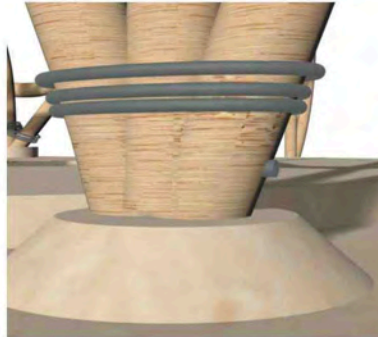

front



top

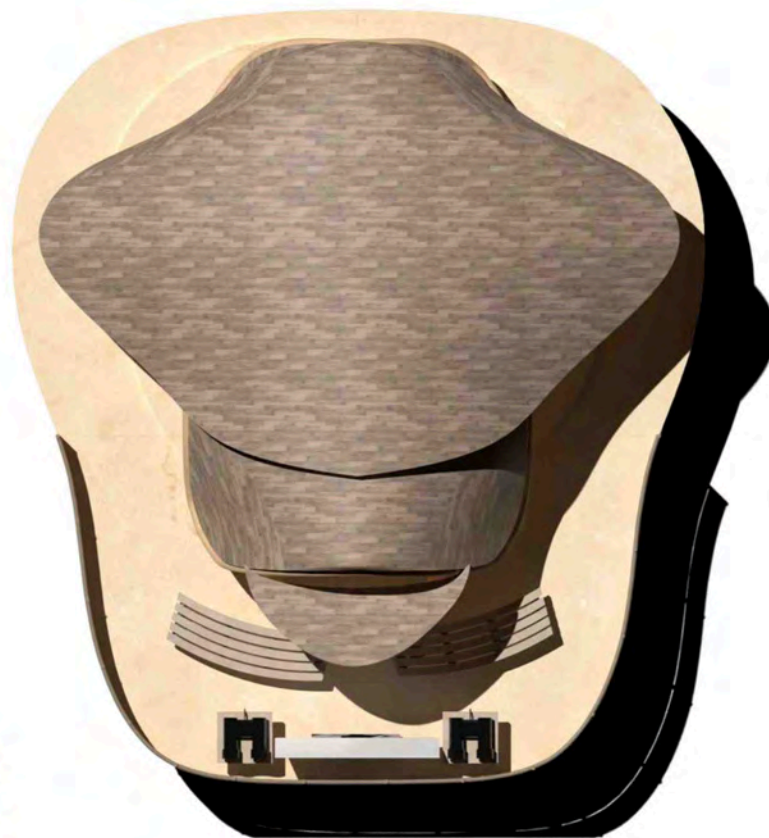

right

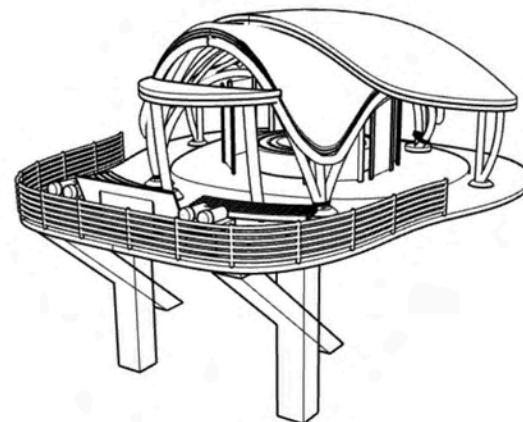



The Aviary

FINAL IMAGES

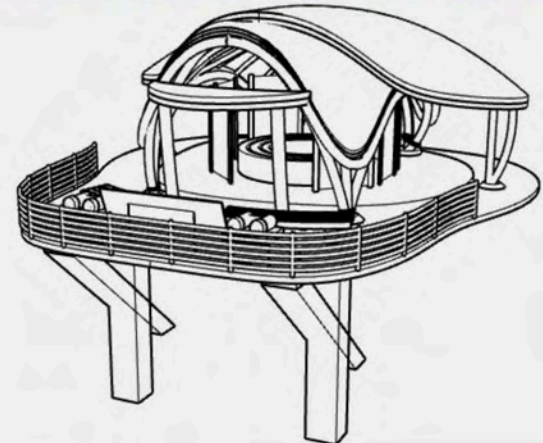
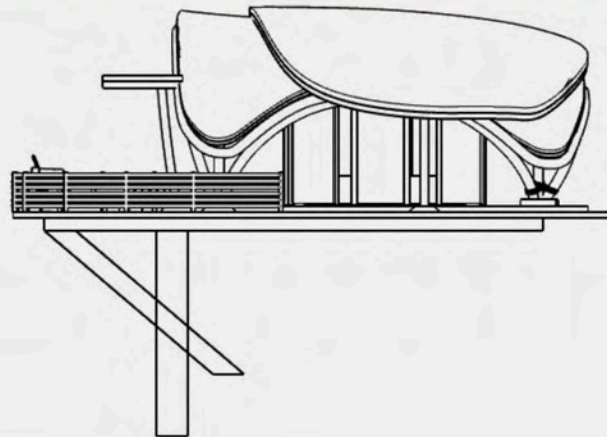
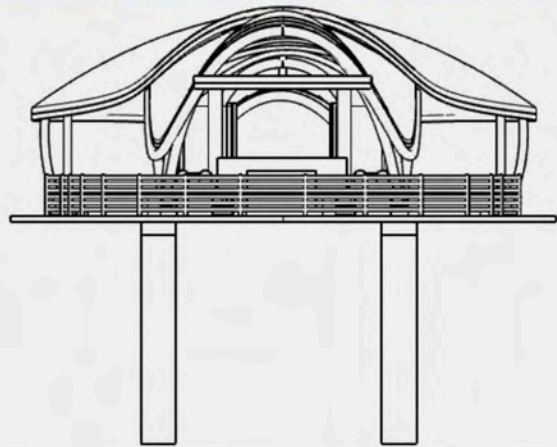

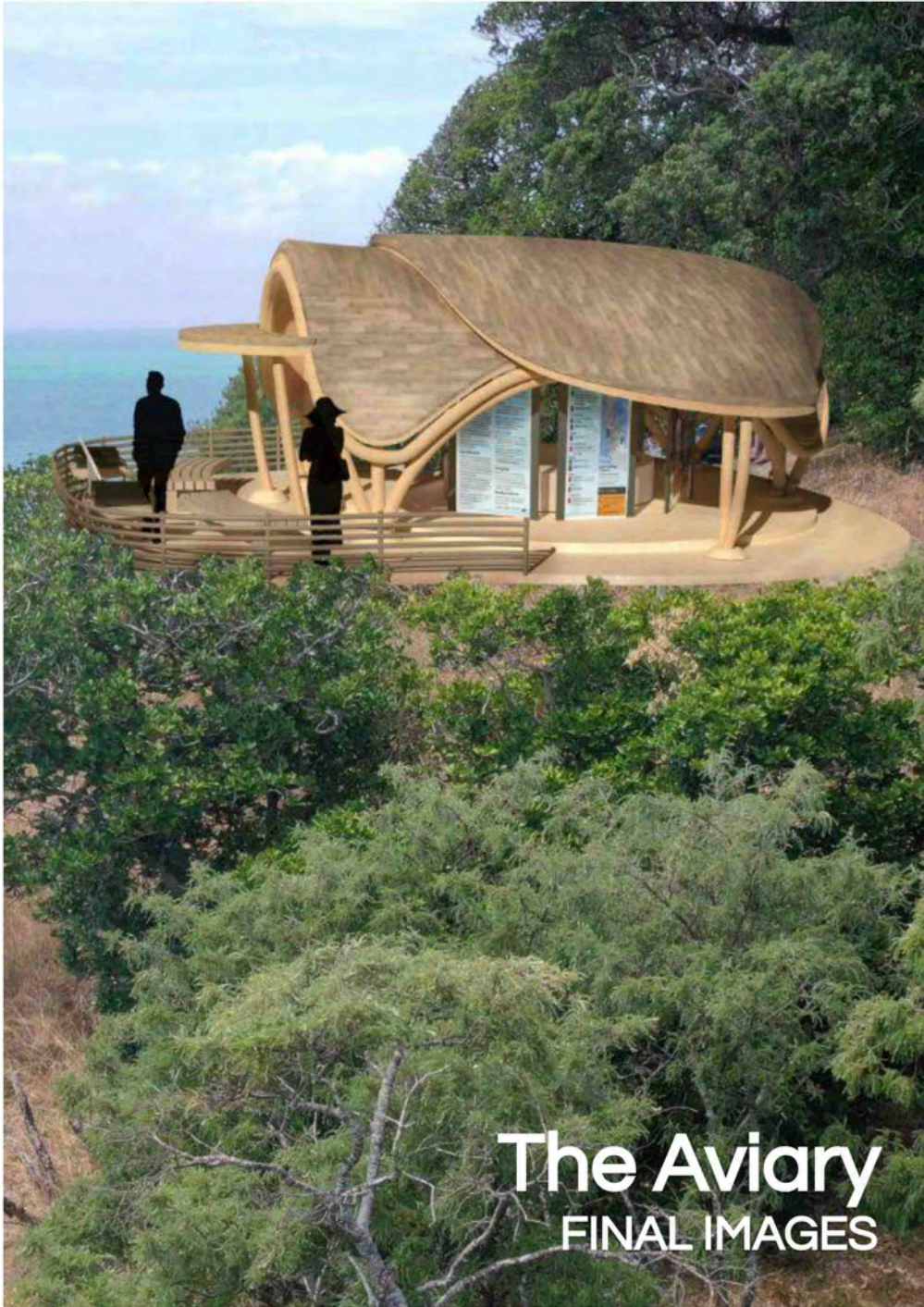



The Aviary
FINAL IMAGES

Sample Excellence exemplar

Subject: Design and Visual Communication

Standard: 91627

Total score: E8

Grade score	Commentary
E8	A mix of birds and the work of Shigeru Ban and Zaha Hadid are reinterpreted and recombined creatively with an aesthetic language that clearly informs the initial design ideas. Ongoing exploration is carried through the frame structure, roof form, handrails, and supporting poles that is intentional and extends and transforms the design in unique and creative ways. Highly refined visual communication convincingly conveys the extensive exploration of the design to consolidate the highest score.